

1 2 3 4 5 6 7 8 9 0

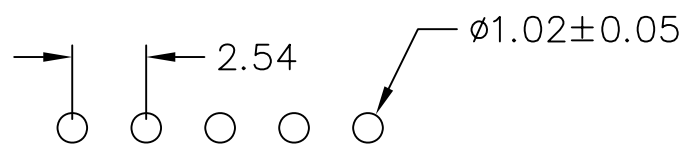
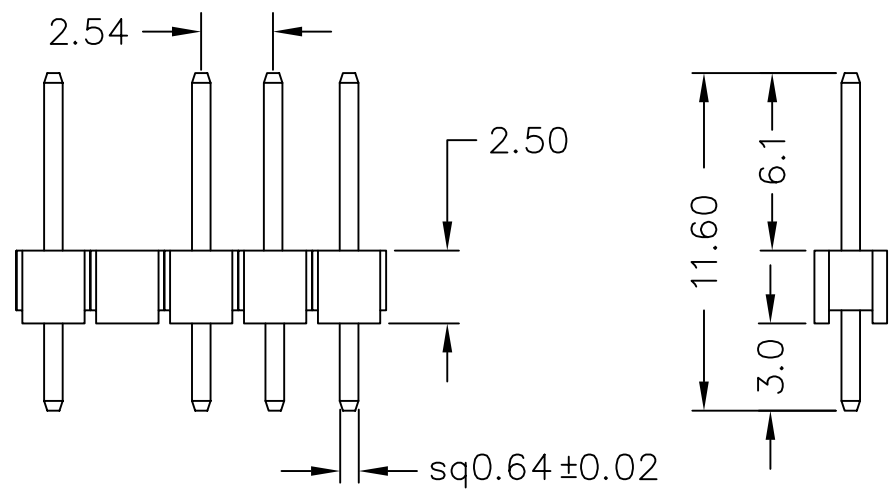
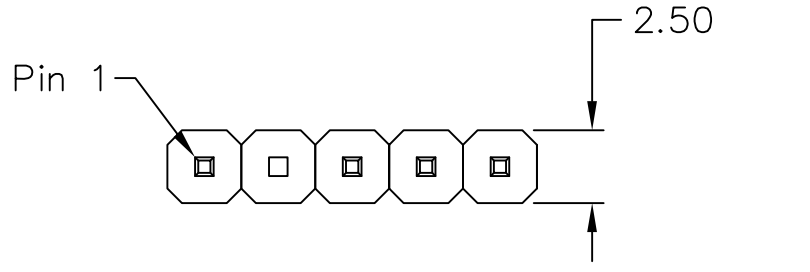

MATERIAL

Insulator : 30% Glass fiber PBT
 Contact Pin : Brass

SPECIFICATION

Current Rate : 3 AMP
 Insulation Resistance : 5000MΩMin. at DC 500V
 Contact Resistance : 20mΩMax. at DC 100mA
 Dielectric Voltage : AC 500V for one minute
 Operation Temperature : -40°C to + 105°C

H-DE2-1X05-LF
 LEADFREE

Recommended P.C.B Layout

RoHS Compliant



PART NO. H-DE2-1X05		APPROVED BY CY		TOLERANCES ARE .X ± 0.3 .XX ± 0.2 .XXX AWG	DESCRIPTION: PIN HEADER 2.54*2.54mm STRAIGHT TYPE, SINGLE ROW
DWG NO. H-DE2-1X05		DRAWING BY			
FILE NO.		PROJECTION		AREA	REVISIONS
UNIT / mm	SCALE 1:1	HK	DATE		

煜倫股份有限公司