

Recommended P.C.B Layout

MATERIAL

Insulator: NY6T UL94-V0
Contact Pin : Brass

SPECIFICATION

Current Rate : 8 AMP PER PIN(20AWG)
Insulation Resistance : 5000MΩMin. at DC 500V
Contact Resistance : 20mΩMax. at DC 100mA
Dielectric Voltage : AC 500V for one minute
Operation Temperature : -40°C to + 105°C

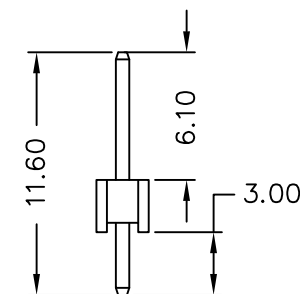

RoHS Compliant

TOLERANCES ARE

MORETHANALL
PCB CONNECTORS
Cable ASSEMBLIES
煜倫股份有限公司
www.morethanall.com

DRAWING BY CY		X. ± .X ± 0.30 .XX ± 0.20 .XXX ± ANG ± 3°
CHECKED BY GENIUS		
UNIT / mm	SCALE 1 : 1	
DATE		
SIZE A4	P PROJECTION	

照片框

ORDER INFORMATION

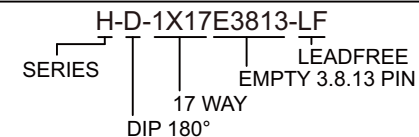

DESCRIPTION: PIN HEADER 2.54*2.54mm STRAIGHT TYPE, SINGLE ROW