

MATERIAL

Insulator : 30% Glass fiber PBT

Contact Pin : Brass

SPECIFICATION

Current Rate : 3 AMP

Insulation Resistance : 5000MΩMin. at DC 500V

Contact Resistance : 20mΩMax. at DC 100mA

Dielectric Voltage : AC 500V for one minute

Operation Temperature : -40°C to + 105°C

H-ATNL-1X02-LF
 NL: NYLON LF: LEADFREE

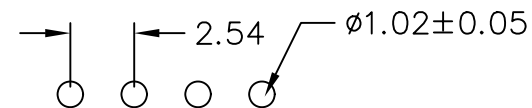

Recommended P.C.B Layout



PART NO. H-AT-1X02

DWG NO. H-AT-1X02

APPROVED BY CY

TOLERANCES ARE

DESCRIPTION:

FILE NO.

DRAWING BY

.X ± 0.3
.XX ± 0.2
.XXX
AWG

AREA

REVISIONS

HK

DATE

煜倫股份有限公司

UNIT / mm

SCALE 1:1

PROJECTION

