

ELECTRICAL CHARACTERISTICS

Contact Current Rating: 3 Amperes.
 Dielectric Withstanding Voltage: AC 500V at sea level.
 Insulation Resistance: 1000 Megohms Min.
 Contact Resistance: 30 Milliohms Max.
 Operation Temperature: -55°C to +105°C.

Material

Contact: Copper Alloy.
 Insulator: PBT. (Select PA6T /LCP /PA9T)
 Shell: SPCC.
 Screw: Copper Alloy.

Note:

No.	A	B	C	D
09	16.33	24.99	30.81	19.23
15	24.66	33.32	39.14	27.56
25	38.38	47.04	53.04	41.28
37	54.84	63.50	69.32	57.33

DS-SS-xx

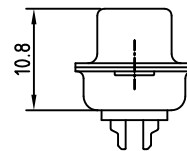

DS-SSN-xx

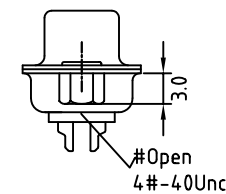

DS-SSJ-xx

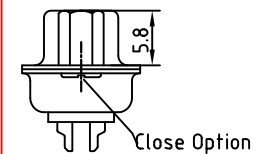

RoHS Compliant

TOLERANCES ARE

MORETHANALL
 PCB CONNECTORS
 Cable ASSEMBLIES

煜倫股份有限公司

www.morethanall.com

DRAWING BY CY

CHECKED BY GENIUS

UNIT / mm SCALE 1 : 1

DATE

SIZE A4

X. ±
 .X ±
 .XX ±
 .XXX ±
 ANG ±

P PROJECTION

照片框

ORDER INFORMATION

DS-SSx-xx-LF
 SERIES | | | LEADFREE
 | | | 09-37 WAY
 N: NUT
 J: JACKSCREW
 FEMALE | | | SOLDER

DESCRIPTION: