

MAXIMUM ELECTRIC CURRENT

| | | | |
|---------|----|----|----|
| A. W. G | 22 | 20 | 18 |
| MAX AMP | 3 | 4 | 7 |

NOTE:

1. MAXIMUM ELECTRICAL RATING: 105 °C 300 VOLTS
2. REINFORCEMENT SLEEVE: D TYPE SLEEVE
3. WIRE RANGE: AWG 22-18/0.5-0.75mm²
INSULATED COLOR: TRANSPARENT

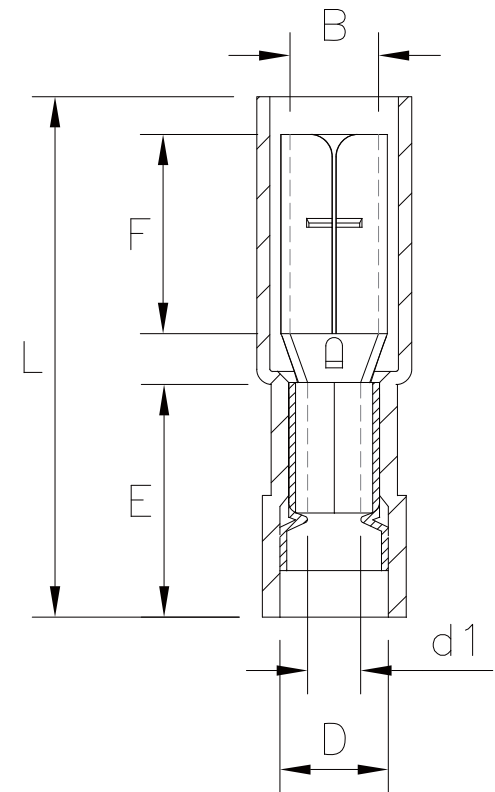

| WIRE RANGE AWG/mm ² | 產品編號 ITEM NO. | B ±0.20 | F ±0.50 | L ±1.00 | E ±0.60 | D ±0.30 | d1 ±0.20 |
|---------------------------------------|------------------|------------|------------|------------|------------|------------|-------------|
| AWG 22-18 0.5-0.75 mm ² | B20-FTNFC-18 | 2.0 | 10.0 | 24.0 | 11.0 | 3.5 | 1.6 |

RoHS Compliant

TOLERANCES ARE

MORETHANALL
PCB CONNECTORS
Cable ASSEMBLIES

DRAWING BY CY

X.±

CHECKED BY GENIUS

.X±

UNIT / mm

SCALE 1:1

.XX±

DATE

.XXX±

ANG±

SIZE A4

PPOJECTION



ORDER INFORMATION

B20-FTNFC-18-LF
SERIES | | | | | LEADFREE
18-22AWG
COPPER
FULL
FEMALE | NYLON
TERMINAL

煜倫股份有限公司

www.morethanall.com

DESCRIPTION: