

Technical Data:

Material:

- Solder Pin: Brass with Tin plated
- Flange Screw nut: Brass Nickel plated M2.5
- Insulator body(housing): Polyamide(Glass filled)(UL94V-0)

Electrical

- Voltage rating: 250VAC
- Current rating: 15A
- Insulation resistance: 500MΩ at DC 500V
- Withstanding Voltage: AC 1500V(1min)

Mechanical:

- Using temperature Range: -40°C to +105°C
- Soldering temperature: +250°, 5seconds Max.

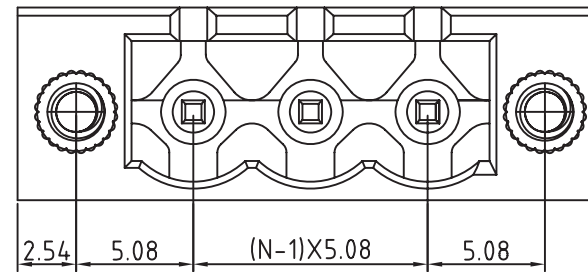

N=Number of contacts

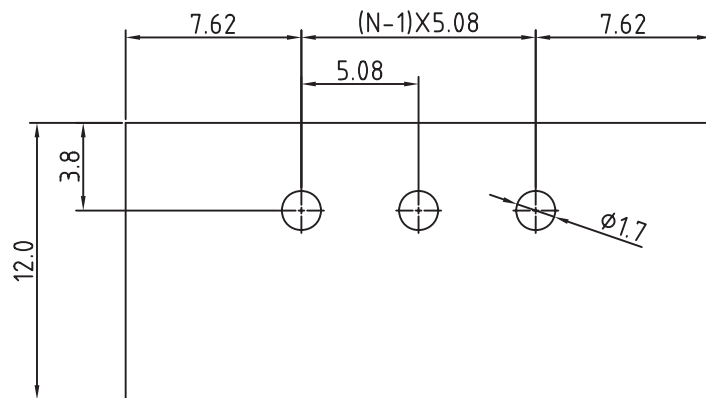

PCB. LAYOUT

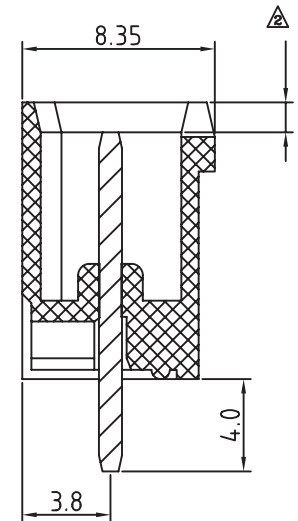
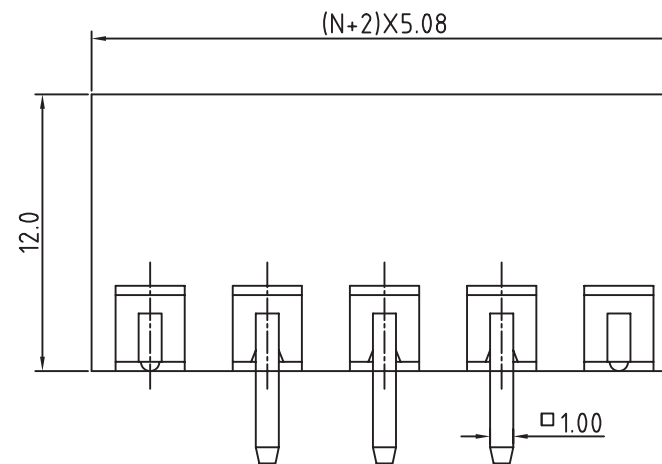

RoHS Compliant

TOLERANCES ARE

MORETHANALL
PCB CONNECTORS
Cable ASSEMBLIES

煜倫股份有限公司

www.morethanall.com

DRAWING BY CY

CHECKED BY GENIUS

UNIT/mm SCALE 1:1

DATE

SIZE A4

X. ±
.X ± 0.30
.XX ± 0.10
.XXX ±
ANG ±

PJECTION

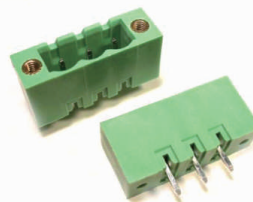

ORDER INFORMATION

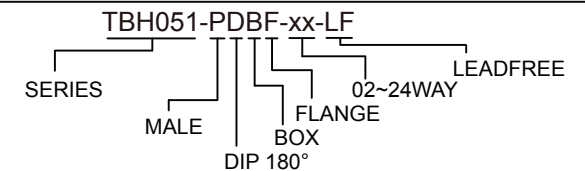

DESCRIPTION: 5.08mm SERIES 180° W/FLANGE