

PS-SE-1Xxx-LF  
LEADFREE

RoHS Compliant

Specifications:  
 Current rating:5.0 AC/DC  
 Voltage rating:250V AC/DC  
 Contact resistance:20m ohm. max.  
 Insulator resistance:1000M ohm. Min.  
 Withstanding voltage:1500V AC for one minute  
 Operating temperature range:-25°C to + 105°C  
 Application wire:AWG#26 TO #18  
 Material and Finish:  
 Insulator:high Temp. Plastic(UL94V-2)

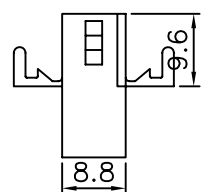
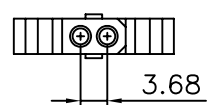

PS-SE-1X02

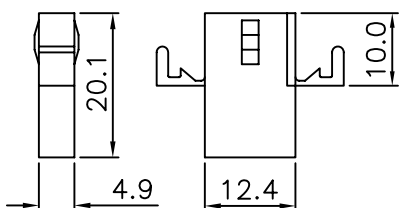
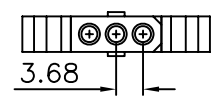

PS-SE-1X03

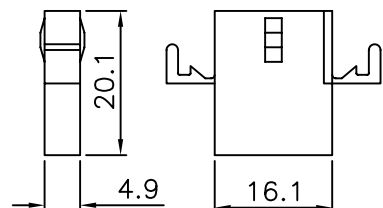
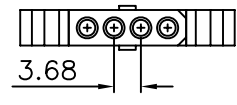

PS-SE-1X04

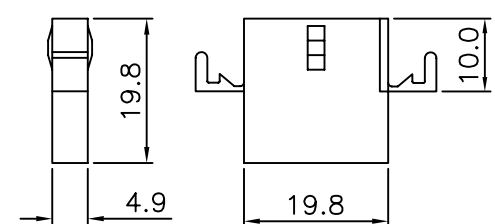
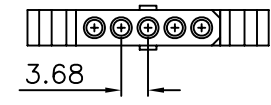

PS-SE-1X05



PART NO. PS-SE-1Xxx

DWG NO. PS-SE-1Xxx

FILE NO.

CHECKED BY CY

DRAWING BY

TOLERANCES ARE  
 .X ± 0.2  
 .XX ±  
 .XXX ±  
 AWG

DESCRIPTION: Plug Housing With Ear

焯倫股份有限公司

UNIT / mm

SCALE 1:1

PROJECTION

AREA

REVISIONS

HK

DATE