

1 2 3 4 5 6 7 8 9 0

J
I
H
G
F
E
D
C
B
A

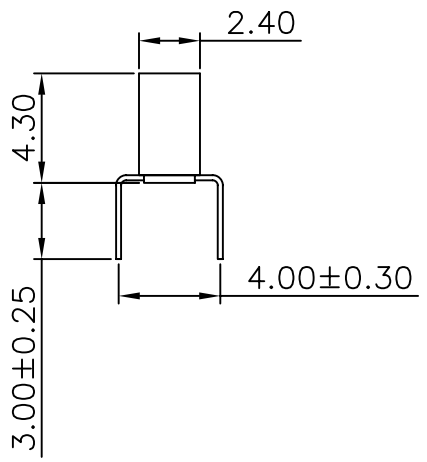
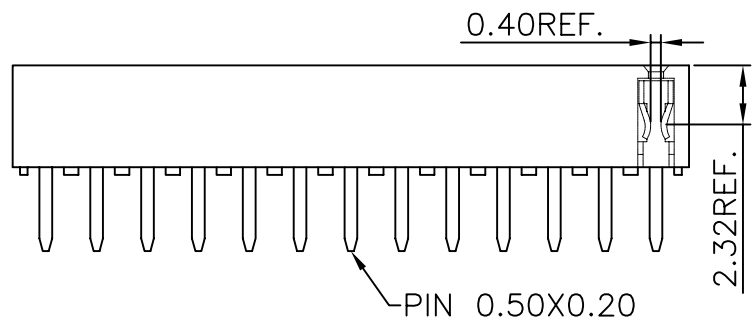
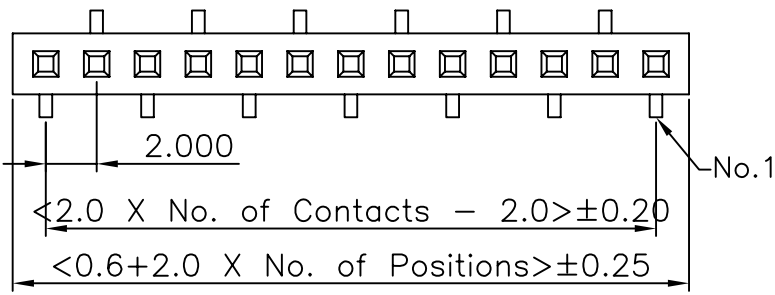

Specifications
 Current Rating: 2Amp
 Insulation Resistance: 1000MΩ Min.
 Dielectric Withstanding: 500V AC
 Contact Resistance: 20mΩ Max.
 Operating Temperature: -40°C to +105°C

Materials
 Contact Material: Phosphor Bronze
 Insulation Material: Polyester, UL 94V-0
 Nylon 6T
 All materials must be GP materials

S-B40-1XxxR-LF
 LEADFREE

RoHS Compliant

Recommended P.C.Board
 Hole Layout
 (Tolerance: ±0.05)

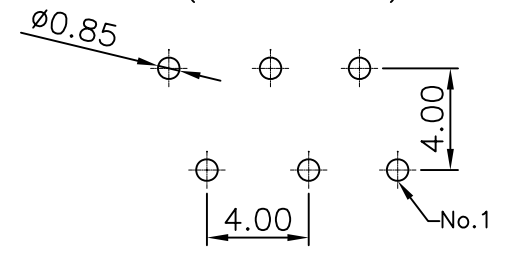

PART NO. S-B40-1XxxR

DWG NO. S-B40-1XxxR

FILE NO.

UNIT / mm

SCALE 1:1

CHECKED BY CY

DRAWING BY

PROJECTION

TOLERANCES ARE
 .X ± 0.2
 .XX ±
 .XXX ±
 AWG

DESCRIPTION:

2.00 FEMALE HEADER SINGLE ROW DIP TYPE
 BASE 4.30H

AREA

REVISIONS

HK

DATE

煜倫股份有限公司