

CONTACT DETAIL

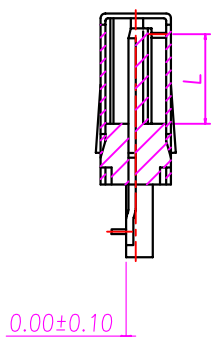

備註 /NOTE:

1. 材質/MATERIAL:
 - 1-1. CONTACT: PHOSPHOR BRONZE
 - 1-2. HOUSING: L.C.P UL94V-0 (黑色 /BLACK)
 - 1-3. METAL SHELL: STAINLESS STEEL
2. 電鍍/PLATING:
 - 2-1. UNDER-PLATE NICKEL ALL OVER.
PLATE TIN/LEAD IN TAIL ZONE.
PLATE GLOD OVER PD/NI IN CONTACT AREA.
 - 2-2. METAL SHELL: UNDER-PLATE NICKEL ALL OVER.

CONTACT POS.	L
1 and 15	3.7
2~14	3.0

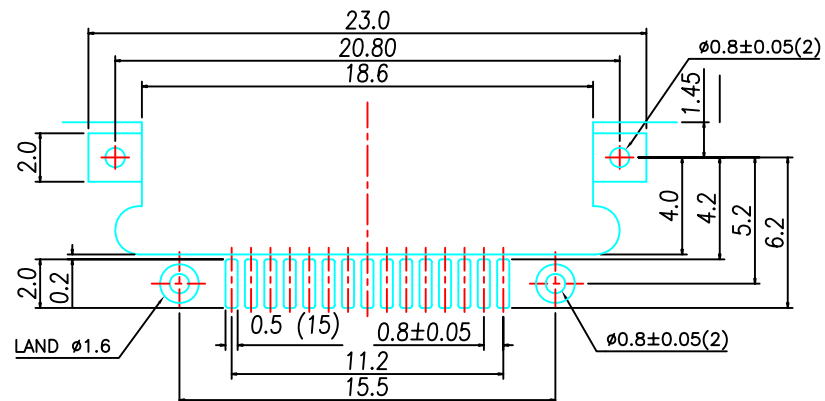

P.C.B LAYOUT
TOP VIEW
TOLERANCES: ±0.1

BOM	
15	CONTACT
1	SHELL
1	HOUSING
數量	零件

RoHS Compliant

TOLERANCES ARE

MORETHANALL
PCB CONNECTORS
Cable ASSEMBLIES

DRAWING BY CY

X, ±

CHECKED BY GENIUS

.X ±

UNIT / mm

SCALE 1 : 1

.XX ±

DATE

.XXX ±

ANG ±

SIZE A4

P PROJECTION

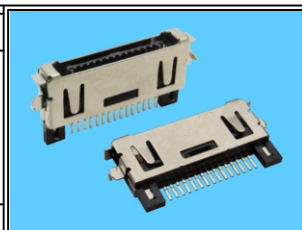

ORDER INFORMATION

PCM-JWF-15A2-LF
SERIES | | | | LEADFREE
| | | | A2 TYPE
JACK | | | | 15 WAY
| | | | OFFSET
| | | | 90°SMT

DESCRIPTION: PCMCIA 15P MALE-A2公座 (OFFSET 0.3)

煜倫股份有限公司

www.morethanall.com