

1 2 3 4 5 6 7 8 9 0

J
I
H
G
F
E
D
C
B
A

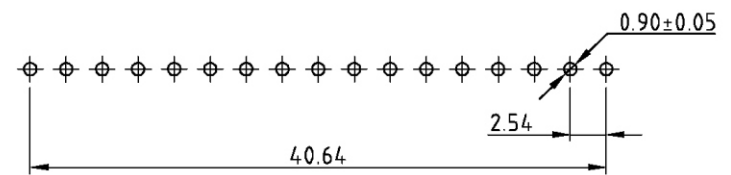

RECOMMENDED PCB LAYOUT

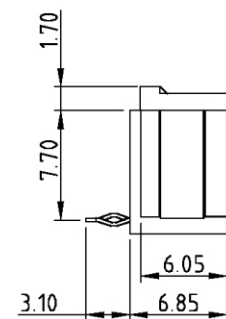
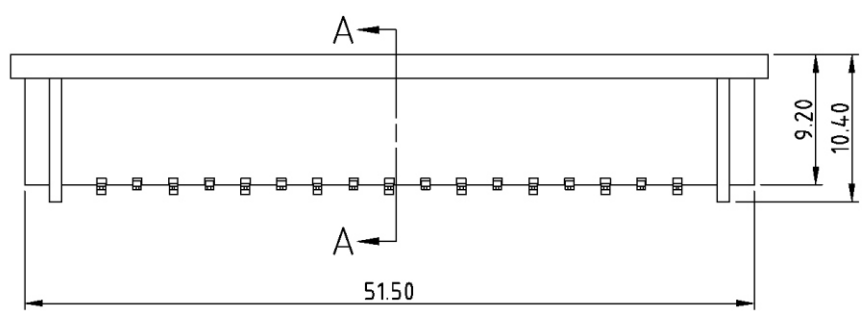
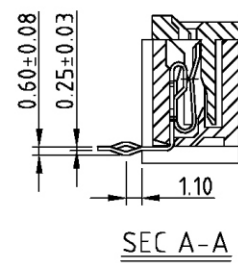
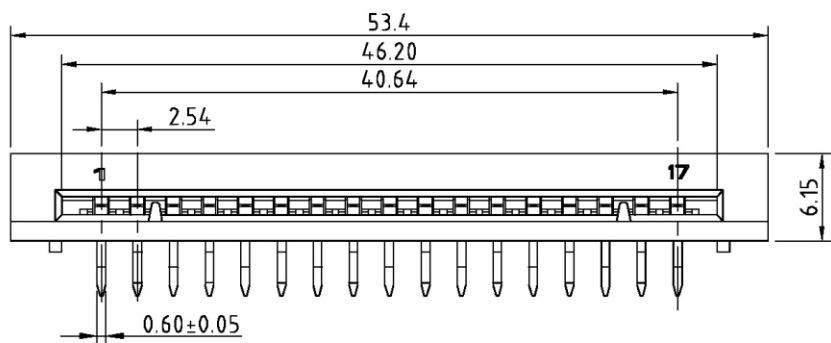
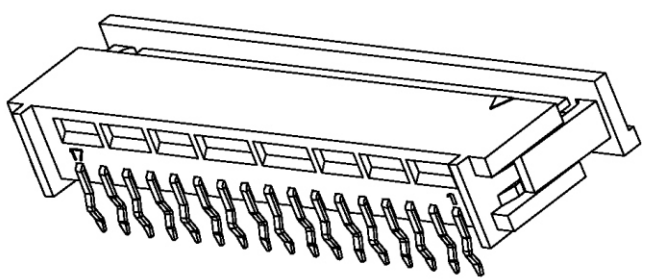
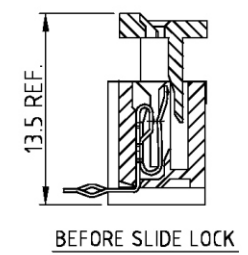

Notes

1. FEATURE:
Insulator: PBT+30% G/F, 94V-0, Black
Contact: Phosphor Bronze, Tin Plating Over Nickel.
2. SPECIFICATION:
Current Rating: 1A AC,DC
Voltage Rating: 250V,AC RMS
Withstanding Voltage: 1000V AC/minute.
Contact Resistance: 25 milliohms max.
Insulation Resistance: 1000 Megohms min.
Temperature range: -40 to + 85 Degree C
Applicable PC Board Thickness: 1.60mm [.063"]

FPC-RZB-17-LF
LEADFREE
RoHS Compliant



PART NO. **FPC-RZB-17**

DWG NO. **FPC-RZB-17**

FILE NO.

UNIT / mm

SCALE 1:1

CHECKED BY CY

DRAWING BY

PROJECTION

TOLERANCES ARE

.X ± 0.2
.XX ±
.XXX ±
AWG

DESCRIPTION:

AREA	REVISIONS	HK	DATE
------	-----------	----	------

煜倫股份有限公司