

DSM-S-09-LF
LEADFREE
RoHS Compliant

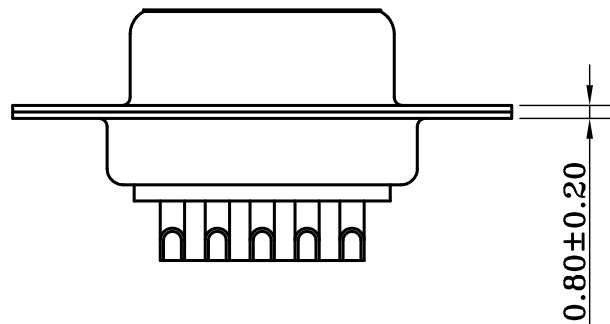

MATERIALS AND FINISH

SHELL : STEEL MATERIAL, FRONT SHELL TIN FINISHED
BACK SHELL TIN FINISHED
DIMPLES ON PLUG ONLY
INSULATOR : PBT THERMOPLASTIC, 30% GLASS FILLED,
UL 94V-0 RATED, BLACK COLOR
SIGNAL CONTACT : COPPER ALLOY, FULL GOLD FLASH

ELECTRICAL CHARACTERISTICS

CONTACT CURRENT RATING : 7.5 AMPS
CONTACT RESISTANCE : 10 mΩ MAX.
DIELECTRIC WITHSTANDING VOLTAGE : 1000 V AC MIN.
INSULATION RESISTANCE : 5GΩ MIN.
TEMPERATURE RATING : -55°C ~ +125°C

MORETHANALL
CONNECTORS
ASSEMBLIES

焜倫股份有限公司

PART NO. DSM-S-09		CHECKED BY CY	TOLERANCES ARE .X ± 0.2 .XX ± .XXX ± AWG	DESCRIP TION:			
DWG NO. DSM-S-09							
FILE NO.		DRAWING BY	AREA REVISIONS HK DATE				
UNIT / mm	SCALE 1:1	PROJECTION					