

Material:

1. Insulator: PBT+30% Glass Fiber(Meet UL94V-0).
2. Contact: Copper Alloy.
3. Contact Plated: Gold Plated.
4. Shell: Steel with Nickel or Tin or Zinc Plated.

Specification:

1. Current Rating: 5 Amps.
2. Withstanding Voltage: AC 500V for 1 Minute.
3. Insulation Resistance: 1000M Min. at DC 500V.
4. Contact Resistance: 15m Max..
5. Operating Temperature: -40°C~+105°C.

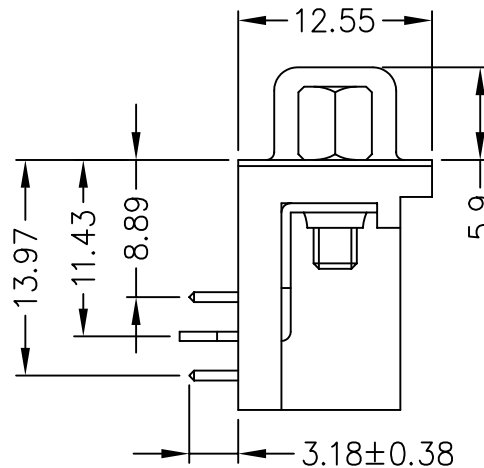
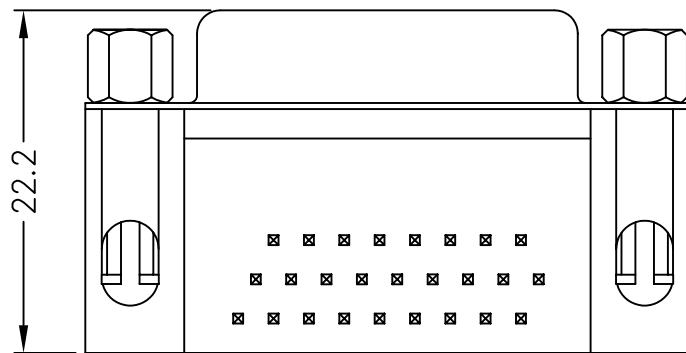

No. of Contacts	Dim. A	Dim. B	Dim. C	Dim. D	Dim. E
15	16.33	24.99	30.81	2.29	0.25
26	24.66	33.32	39.14	2.29	0.51
44	38.38	47.04	53.04	2.29	0.51
62	54.84	63.50	69.32	2.41	0.58

RoHS Compliant

TOLERANCES ARE

MORETHANALL
PCB CONNECTORS
Cable ASSEMBLIES

DRAWING BY CY

CHECKED BY GENIUS

UNIT / mm

SCALE 1 : 1

DATE

SIZE A4

PJECTION

X.±
.X±
.XX±
.XXX±
ANG±

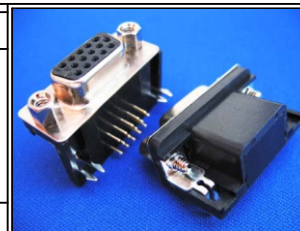

ORDER INFORMATION

HDR-SG-xx-LF
SERIES | LEADFREE
| 15-62 WAY
| FULL GOLD
| FEMALE

煜倫股份有限公司

www.morethanall.com

DESCRIPTION: Hi-Density D-Sub Right Angle Female Connector 8.89mm With Locking Screw Type