

Specifications:

Current Rating:3.0A AC/DC
 Voltage Rating:250 AC/DC
 Contact Resistance:20m ohm. max.
 Insulation Resistance:1,000M ohm. min.
 Dielectric Withstanding:600V AC/Minute
 Operating Temperature Range:-40°C ~ +105°C
 Materials:

Insulator:High Temp. Plastic (PBT UL94V-0)
 Insulator Color:Black
 Contact:Brass
 Plating: **Selective Gold Plated**

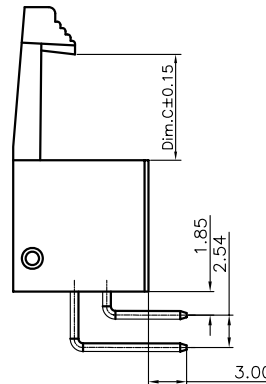
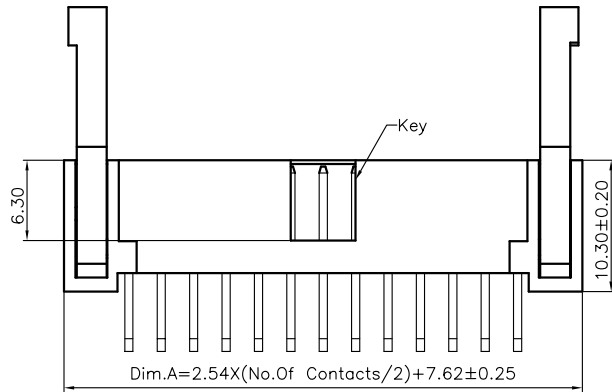

FL-Rx-xx-LF
 LEADFREE
 BLANK:8.3mm LONG/LATCH
 S:4.4mm SHORT/LATCH
 RoHS Compliant

Dimension :

| Pos | Dim A | Dim B | Pos | Dim A | Dim B | Pos | Dim A | Dim B |
|-----|-------|-------|-----|-------|-------|-----|-------|-------|
| 6 | 15.24 | 5.08 | 16 | 27.94 | 17.78 | 34 | 50.80 | 40.64 |
| 8 | 17.78 | 7.62 | 20 | 33.02 | 22.86 | 40 | 58.42 | 48.26 |
| 10 | 20.32 | 10.16 | 24 | 38.10 | 27.94 | 50 | 71.12 | 60.96 |
| 12 | 22.86 | 12.70 | 26 | 40.64 | 30.48 | 60 | 83.82 | 73.66 |
| 14 | 25.40 | 15.24 | 30 | 45.72 | 35.56 | 64 | 88.90 | 78.74 |

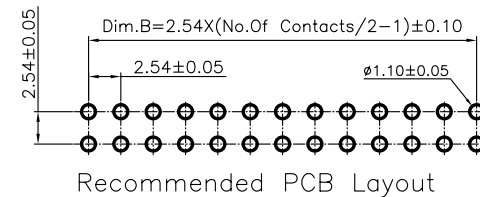

PART NO. FL-Rx-xx

DWG NO. FL-Rx-xx

CHECKED BY CY

TOLERANCES ARE

DESCRIP TION: 2.54mm Box Header Right Angle Type

FILE NO.

DRAWING BY

.X ± 0.2
.XX ± 0.1
.XXX ±
AWG

AREA REVISIONS HK DATE

UNIT / mm

SCALE 1:1

PROJECTION

煜倫股份有限公司