

FEATURES:

- 24 pos interface bus connector
- Cable(24) conductors 24AWG 26AWG
- Connector kits available too for assembly fabrication
- Consists of two rack and panel type
- Design includes a Two-Piece ABS material RF shield enclosing the 24 pos back to back connector

MATERIALS:

- Housing And Cover: thermoplastic P.B.T UL94V-0 black
- Contacts: Phosphor bronze gold selective plated

ELECTRICAL:

- Current Rating: 1 Amp
- Insulation Resistance: 500MΩ/Min
- Withstanding Voltage: 500V AC/Min
- Contact Resistance: 35mΩ Max
- Temperature Range: -55°C ~ +105°C

CTA-C-24-LF
 CHROMATE LEADFREE
 RoHS Compliant

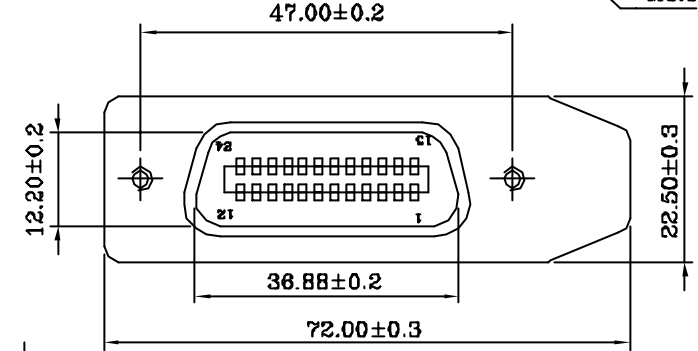
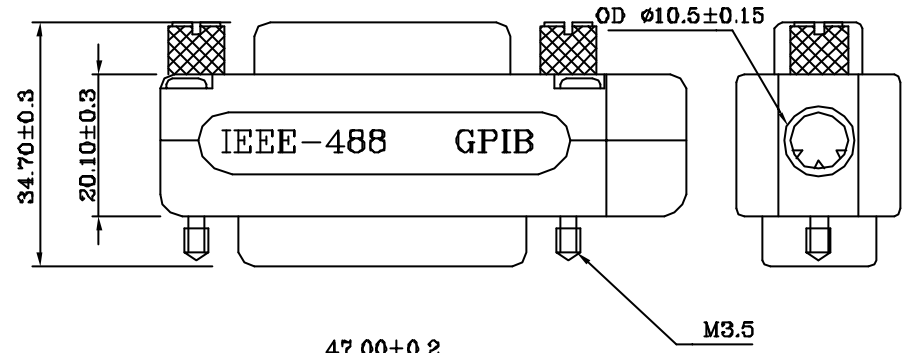
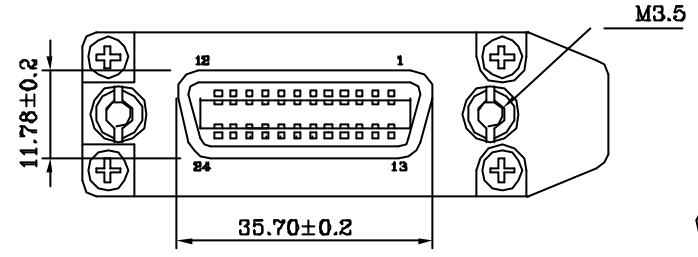
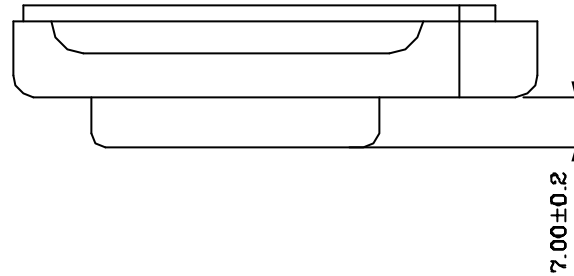
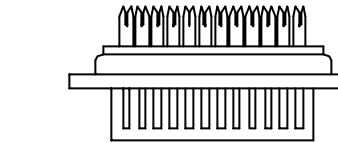
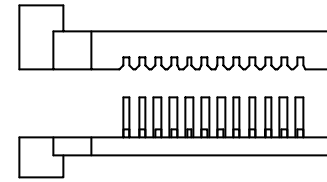
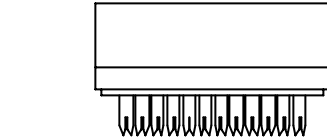
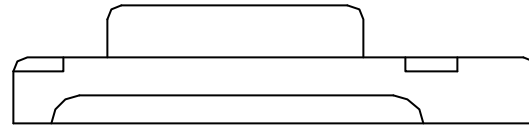

PART NO. CTA-C-24

DWG NO. CTA-C-24

CHECKED BY CY

TOLERANCES ARE

DESCRIPTION:

Connectors For Interface Bus Applications PER IEEE STD.488 (GPIB) ABS Metalized

煜倫股份有限公司

FILE NO.

DRAWING BY

.X ± 0.2
.XX ±
.XXX ±
AWG

AREA

REVISIONS HK DATE

UNIT / mm

SCALE 1:1

PROJECTION