

1 2 3 4 5 6 7 8 9 0

J  
I  
H  
G  
F  
E  
D  
C  
B  
A

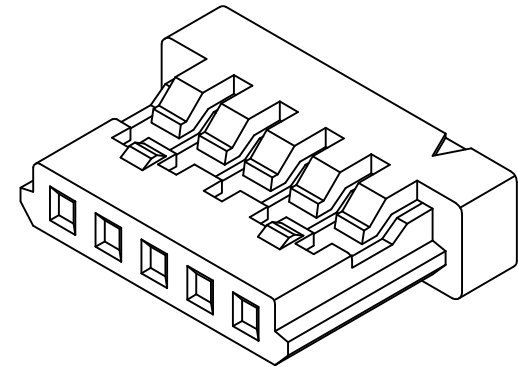
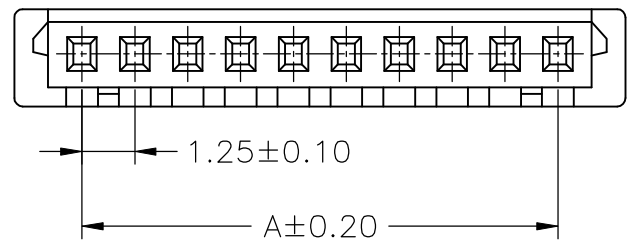

**SPECIFICATIONS**  
 Current Rating: 1A AC,DC  
 Voltage Rating: 100V AC,DC  
 Temperature Range: -25°C ~ +85°C  
 Contact Resistance: 20mΩ Max.  
 Insulation Resistance: 500MΩ Min.  
 Withstanding Voltage: 500V AC/minute  
 Material: Nylon 66,UL94V-0

**DF14-H-xx-LF**  
 LEADFREE

RoHS Compliant

Ordering Information & Dimensions

PART NO.	Dimensions	
	A	B
<b>DF14-H-02</b>	1.25	4.45
<b>DF14-H-03</b>	2.50	5.70
<b>DF14-H-04</b>	3.75	6.95
<b>DF14-H-05</b>	5.00	8.20
<b>DF14-H-06</b>	6.25	9.45
<b>DF14-H-07</b>	7.50	10.70
<b>DF14-H-08</b>	8.75	11.95
<b>DF14-H-09</b>	10.00	13.20
<b>DF14-H-10</b>	11.25	14.45
<b>DF14-H-11</b>	12.50	15.70
<b>DF14-H-12</b>	13.75	16.95
<b>DF14-H-13</b>	15.00	18.20
<b>DF14-H-14</b>	16.25	19.45
<b>DF14-H-15</b>	17.50	20.70
<b>DF14-H-20</b>	23.75	26.95
<b>DF14-H-25</b>	30.00	33.20
<b>DF14-H-30</b>	36.25	39.45

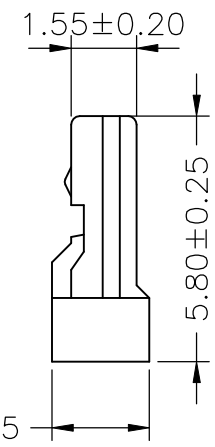
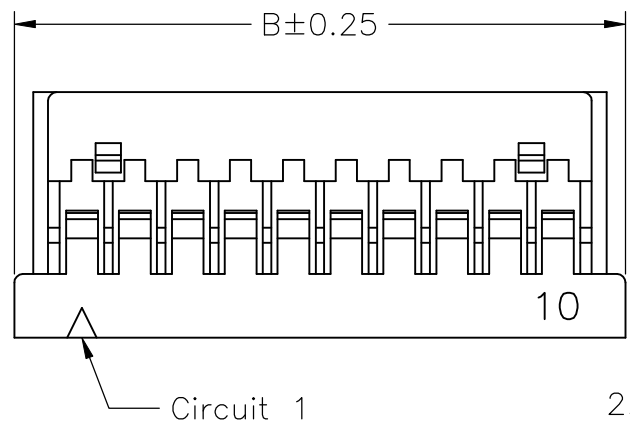

2.30±0.25



PART NO. **DF14-H-xx**

DWG NO. **DF14-H-xx**

CHECKED BY CY

TOLERANCES ARE

DESCRIP TION: **1.25mm PITCH HOUSING  
ULTRA LOW PROFILE**

FILE NO.

DRAWING BY

.X ± 0.2  
.XX ±  
.XXX ±  
AWG

AREA	REVISIONS	HK	DATE
------	-----------	----	------

UNIT / mm

SCALE 1:1

PROJECTION

煜倫股份有限公司