

Specifications

Current Rating: 2Amp
 Insulation Resistance: 1000MΩ Min.
 Dielectric Withstanding: 500V AC/DC
 Contact Resistance: 20mΩ Max.
 Operating Temperature: -40°C to +105°C

Materials

Contact Material: Phosphor Bronze
 Insulation Material: Polyester, UL 94V-0
 Nylon-6T

S-R43-1Xxx-LF
 LEADFREE

RoHS Compliant

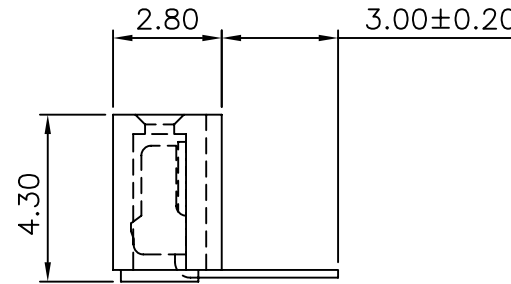
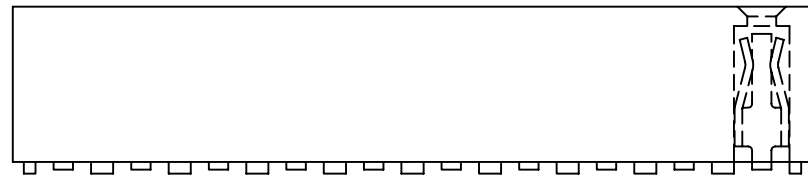

Recommended P.C.Board
 Hole Layout

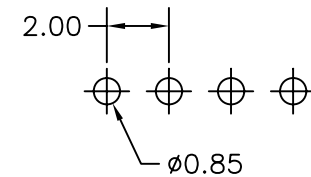

PART NO. S-R43-1Xxx		CHECKED BY CY		TOLERANCES ARE .X ± 0.38 .XX ± 0.25 .XXX ± 0.13 AWG	DESCRIPTION: 2.00 FEMALE HEADER SINGLE ROW R/A TYPE BASE 4.30	AREA	REVISIONS	HK	DATE
DWG NO. S-R43-1Xxx		DRAWING BY							
FILE NO.		PROJECTION							
UNIT / mm	SCALE 1:1								

煜倫股份有限公司