

POSITION	A	B	C
DRM-PG-09	16.92	25.00	30.8
DRM-PG-15	25.25	33.30	39.2
DRM-PG-25	38.96	47.10	53.1
DRM-PG-37	55.42	63.50	69.4

SPECIFICATION

MATERIAL

Insulator: Thermal Plastic UL94V-0

Contacts: Copper Alloy

Shell: Steel

Rivet, Boardlock: Copper Alloy

CONTACT PLATING

Underplate: 50u" Nickel

Contact Area: 1u"~30u" Selective Gold

Solder Tails Area: 100u"~200u" Tin/Lead(Brighten Tin)or

100u"~200u" Tin/Lead Free(Brighten Tin/Matte Tin)

ELECTRICAL

Operation Voltage: 250 VAC Max.

Current Rating: 3 Amps

Contact Resistance: 15 mohms

Insulation Resistance: 3000 Mohms Min @ 500 VDC

Dielectric Withstanding Voltage: 1000 VAC / Minute

Temperature Range: -55°C TO +105°C

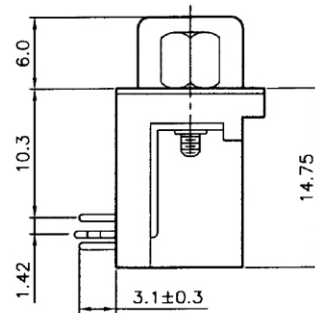
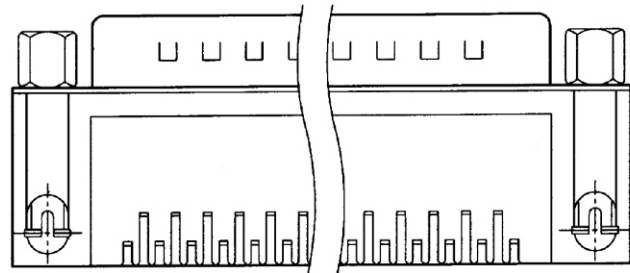

DRM-PG-xx-LF

LEADFREE

RoHS Compliant

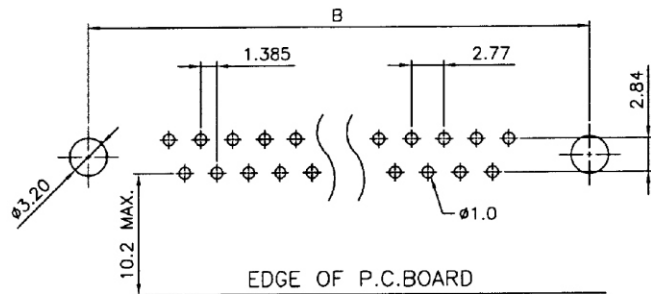

RECOMMENDED P.C.B LAYOUT (TOP VIEW)
TOLERANCES: ±0.05mm

MORETHANALL
CONNECTORS
ASSEMBLIES

PART NO. DRM-PG-xx

DWG NO. DRM-PG-xx

FILE NO.

CHECKED BY CY

DRAWING BY

TOLERANCES ARE

.X ± 0.2

.XX ±

.XXX ±

AWG

DESCRIPTION:

焯倫股份有限公司

UNIT / mm

SCALE 1:1

PROJECTION

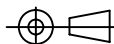

AREA

REVISIONS

HK

DATE