

Pos	A	B	C
4	7.00	3.81	5.60
6	9.54	6.35	8.14
8	12.08	8.89	10.68
10	14.62	11.43	13.22
12	17.16	13.97	15.76
14	19.70	16.51	18.30
16	22.24	19.05	20.84
18	24.78	21.59	23.38
20	27.32	24.13	25.92
22	29.86	26.67	28.46
24	32.40	29.21	31.00
26	34.94	31.75	33.54

Specifications:
 Current rating:1.0A AC,DC
 Voltage rating:250V AC, DC
 Contact resistance:20m ohm Max
 Insulation resistance:1000M ohm Min
 Withstanding voltage:AC 500V AC/minute
 Operating Temperature:-40°C ~ +105°C
 Materials:
 Insulator:High Temp Plastic UL94V-0
 Contact material:Phosphor Bronze
 Finish:Tin Plated

MIM-SVC-xx-LF
 LEADFREE

RoHS Compliant

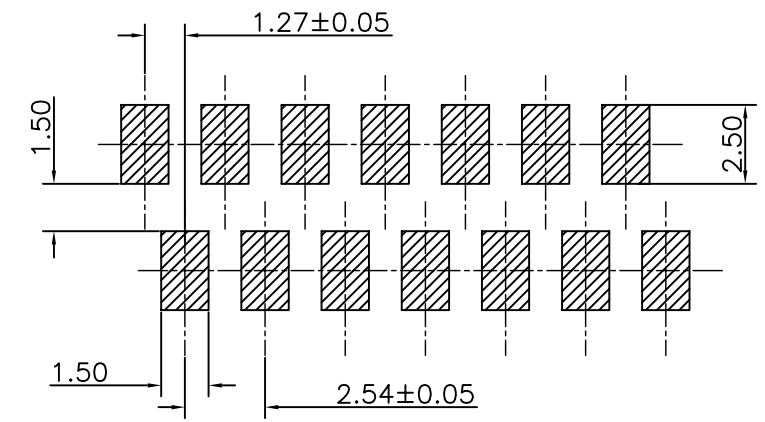
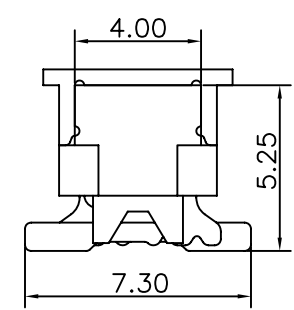
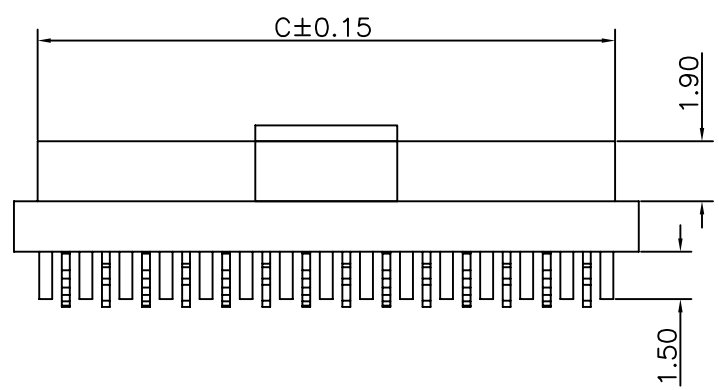

PCB Layout

MORETHANALL
 CONNECTORS
 ASSEMBLIES

PART NO. MIM-SVC-xx
 DWG NO. MIM-SVC-xx
 FILE NO.
 UNIT / mm SCALE 1:1

CHECKED BY CY
 DRAWING BY
 PROJECTION

TOLERANCES ARE
 .X±0.2
 .XX±
 .XXX±
 AWG

DESCRIPTION:	2.54mm PCB Connector SMD Type			
AREA	REVISIONS	HK	DATE	

焜倫股份有限公司