

PCB LAYOUT COMPONENT SIDE

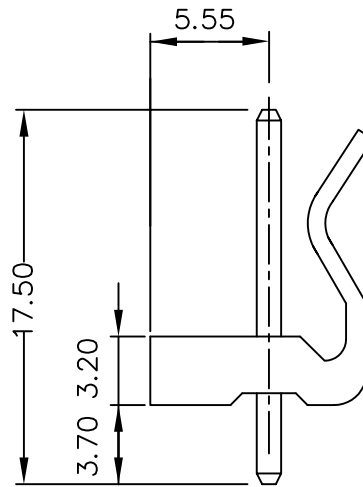
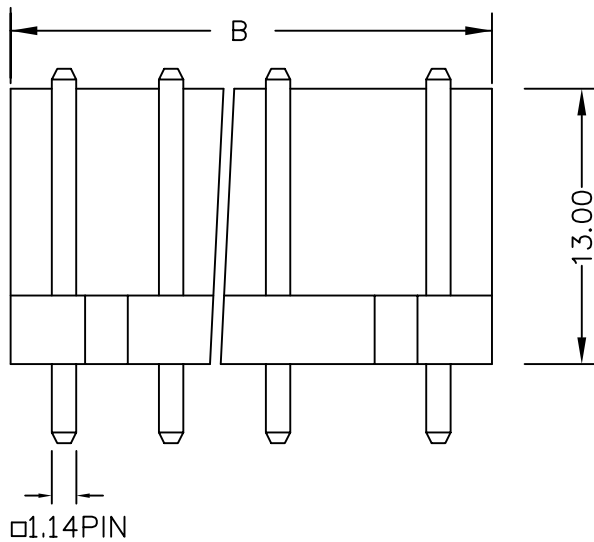

SPECIFICATIONS

Electrical

Current Rating: 5A AC, DC

Voltage Rating: 250V AC, DC

Operating Temp.: -25°C ~ +85°C

Insulation Resistance: 1000M Ω / min.

Dielectric Withstanding Voltage: 1500V AC/ min.

Contact Resistance: 10m Ω / max.

Material

Material: Nylon66, UL94V-2

Poles	Dimension mm (in.)		Part No.	Note.
	A	B		
2	7.50	12.40	VK-D-02	
3	12.50	17.40	VK-D-03	
4	17.50	22.40	VK-D-04	
5	22.50	27.40	VK-D-05	
6	27.50	32.40	VK-D-06	
7	32.50	37.40	VK-D-07	

RoHS Compliant

TOLERANCES ARE

MORETHANALL
PCB CONNECTORS
Cable ASSEMBLIES

煜倫股份有限公司

www.morethanall.com

DRAWING BY CY

CHECKED BY GENIUS

UNIT / mm

SCALE 1 : 1

DATE

SIZE A4

PJECTION

X. ± 0.50

.X ± 0.10

.XX \pm

.XXX \pm

ANG \pm

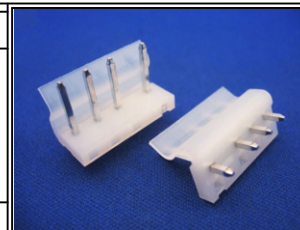

ORDER INFORMATION

VK-D-xx-LF
SERIES | LEADFREE
02~07 WAY
DIP 180°

DESCRIPTION: 7.5/5.0mm Wire-to-Board Header Dip 180° Type