

4.20±0.05
A±0.10

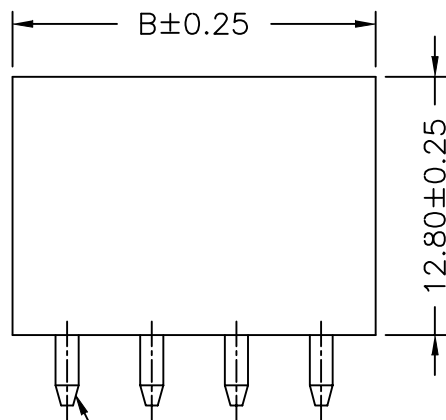

PIN 1.14 SQ

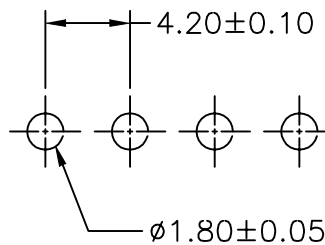

P.C.B LAYOUT

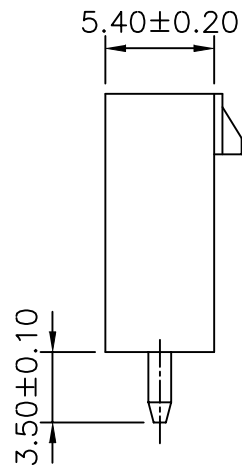

SPECIFICATIONS

Current Rating: 7A AC,DC
 Voltage Rating: 250V AC,DC
 Temperature Range: -25°C ~ +85°C
 Contact Resistance: 10mΩ Max
 Insulation Resistance: 1000MΩ Min
 Withstanding Voltage: 1500V AC/minute
 Pin Material: Brass/Tin-plated
 Material: Nylon 66,UL94V-2

Ordering Information & Dimensions

PART NO.	Dimensions	
	A	B
MF-PDX-1X03	8.40	13.80
MF-PDX-1X04	12.60	18.00
MF-PDX-1X05	16.80	22.20

MORETHANALL
CONNECTORS
ASSEMBLIES

煜倫有限公司

PART NO. MF-PDX-1Xxx

DWG NO. MF-PDX-1Xxx

FILE NO.

UNIT / mm

SCALE 1:1

CHECKED BY CY

DRAWING BY

PROJECTION



TOLERANCES ARE

.X±
.XX±
.XXX±
AWG

DESCRIPTION:

4.20mm PITCH
180° WAFER, MINI-FIT

AREA

REVISIONS

HK

DATE