

## SPECIFICATIONS

Current rating : 2.5A AC,DC

Voltage rating : 250V AC,DC

Temperature range : -25°C to +85 °C

Contact resistance : 10mΩ Max.

Insulation resistance : 1000MΩ Min.

Withstanding voltage : 800V AC/minute

Material : Nylon 66, UL94V-0

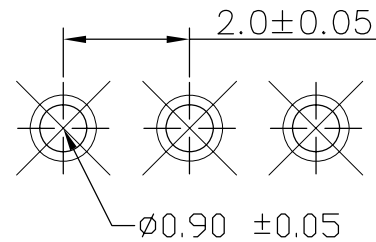
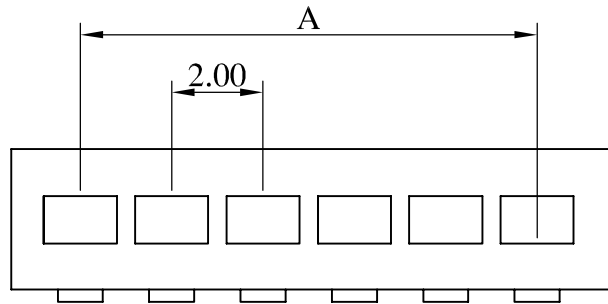

P.C.B Layout

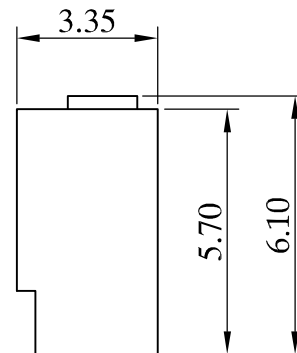
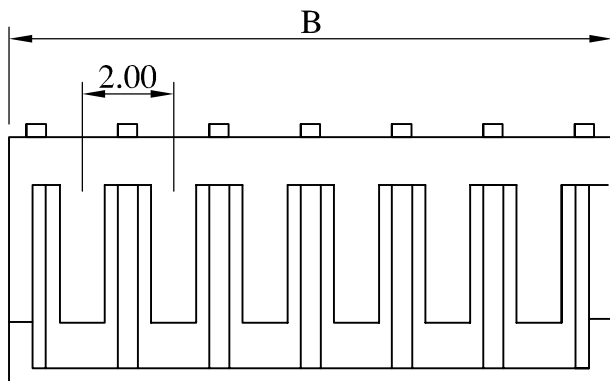

## Ordering Information & Dimensions

Poles	Dimension (mm)		Part No.	Note.
	A	B		
2	2.00	5.20	SAN-H-02	
3	4.00	7.20	SAN-H-03	
4	6.00	9.20	SAN-H-04	
5	8.00	11.20	SAN-H-05	
6	10.00	13.20	SAN-H-06	
7	12.00	15.20	SAN-H-07	
8	14.00	17.20	SAN-H-08	
9	16.00	19.20	SAN-H-09	
10	18.00	21.20	SAN-H-10	
11	20.00	23.20	SAN-H-11	
12	22.00	25.20	SAN-H-12	
13	24.00	27.20	SAN-H-13	
14	26.00	29.20	SAN-H-14	
15	28.00	31.20	SAN-H-15	
16	30.00	33.20	SAN-H-16	

RoHS Compliant

TOLERANCES ARE

**MORETHANALL**  
PCB CONNECTORS  
Cable ASSEMBLIES

DRAWING BY CY

CHECKED BY GENIUS

UNIT / mm

SCALE 1 : 1

DATE

SIZE A4

X, ±  
.X ± 0.25  
.XX ± 0.15  
.XXX ±  
ANG ±

PPOJECTION

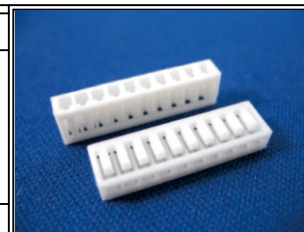

ORDER INFORMATION

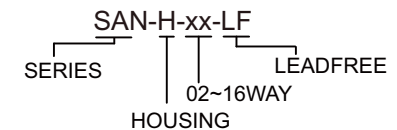

DESCRIPTION: 2.00mm Board-In 180° Housing

煜倫股份有限公司

www.morethanall.com