

PCB Layout
(Top View)

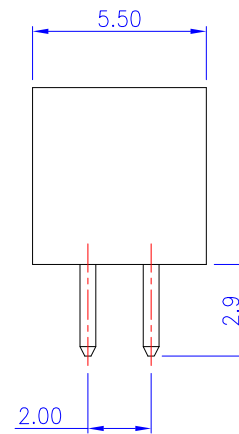
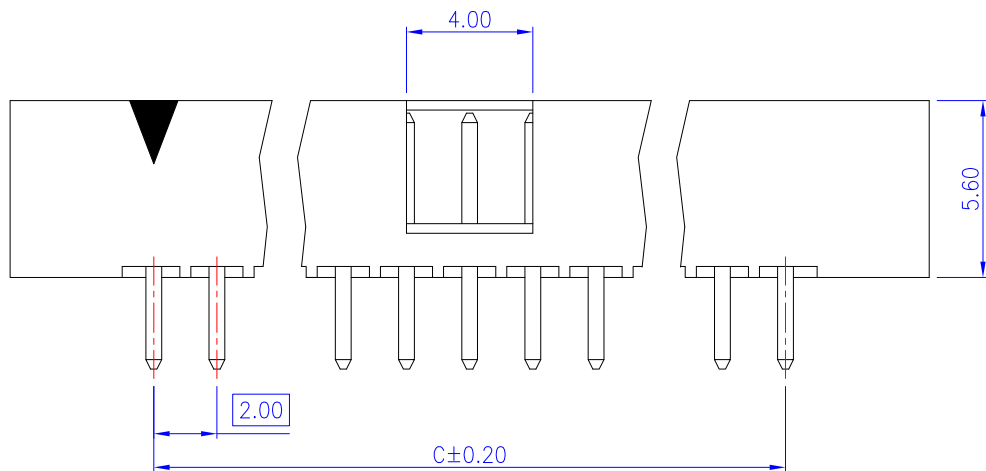

Dimensions				Dimensions			
Pos.	A	B	C	Pos.	A	B	C
06	13.20	12.10	4.00	28	35.20	34.10	26.00
08	15.20	14.10	6.00	30	37.20	36.10	28.00
10	17.20	16.10	8.00	32	39.20	38.10	30.00
12	19.20	18.10	10.00	34	41.20	40.10	32.00
14	21.20	20.10	12.00	36	43.20	42.10	34.00
16	23.20	22.10	14.00	40	47.20	46.10	38.00
18	25.20	24.10	16.00	44	51.20	50.10	42.00
20	27.20	26.10	18.00	50	57.20	56.10	48.00
22	29.20	28.10	20.00	60	67.20	66.10	58.00
24	31.20	30.10	22.00	64	71.20	70.10	62.00
26	33.20	32.10	24.00	68	75.20	74.10	66.00

Material and Finish

1. Housing: Thermoplastic (UL94V-0), Black.
2. Terminal: Sq. 0.50mm Copper Alloy, Gold Plating.

Electrical Characteristics

1. Current Rating: 1.0 Amp. Max..
2. Dielectric Withstand Voltage:
800V AC RMS for 60Seconds.
3. Insulation Resistance:
1000M Ohms Min. at 500V DC.

Mechanical Characteristics

1. Operating Temperature: -55°C ~ +105°C

RoHS Compliant

TOLERANCES ARE



煜倫股份有限公司

www.morethanall.com

DRAWING BY CY

CHECKED BY GENIUS

UNIT / mm

SCALE 1 : 1

DATE

SIZE A4

PJECTION

X, ±
.X ± 0.30
.XX ± 0.20
.XXX ± 0.10
ANG ±

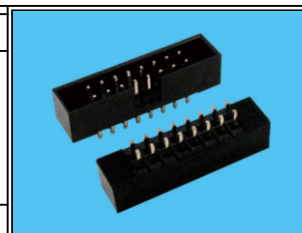

ORDER INFORMATION

MB-D-xxx-LF
SERIES | LEADFREE
006~068WAY
DIP 180°

DESCRIPTION: