

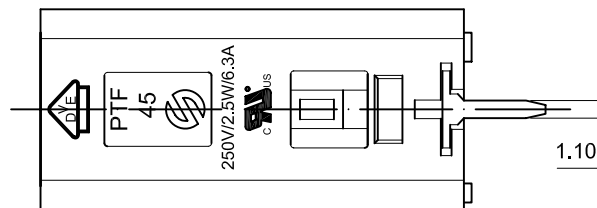

Recommend mounting holes

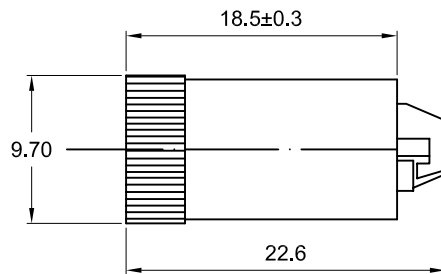

FUSE HOLDER PANEL MOUNT TYPE FOR FUSES

5.2X20mm   APPROVED

SPECIFICATIONS:

- \*Rated current: 6.3A 250V
- \*Insulation resistance at 500V DC: 100MΩ Min.
- \*Contact resistance: 5mΩ at 1A DC
- \*Dielectric strength for 60 seconds: AC 1000V min.
- \*Plastic material for body and cover: PBT
- \*Insulating body: Flame retarding UL94V0 thermoplastic material.
- \*Contact: Nickel or tin plated copper alloy

RoHS Compliant

TOLERANCES ARE

**MORETHANALL**  
PCB CONNECTORS  
Cable ASSEMBLIES  
煜倫股份有限公司

DRAWING BY CY

CHECKED BY GENIUS

UNIT / mm SCALE 1 : 1

DATE

SIZE A4

X, ±  
.X ±  
.XX ±  
.XXX ±  
ANG ±

P PROJECTION 



ORDER INFORMATION

FSH-U10-5X20-LF  
SERIES | LEADFREE  
5X20mm  
10.0mm  
UPRIGHT

DESCRIPTION:

www.morethanall.com