

1 2 3 4 5 6 7 8 9 0

J  
I  
H  
G  
F  
E  
D  
C  
B  
A

Specifications  
 Current Rating: 2Amp  
 Insulation Resistance: 1000MΩ Min.  
 Dielectric Withstanding: 500V AC/DC  
 Contact Resistance: 20mΩ Max.  
 Operating Temperature: -40°C to +105°C

Materials  
 Contact Material: Phosphor Bronze  
 Insulation Material: Polyester, UL 94V-0  
 NYLON-6T  
 All materials must be GP materials

S-V45X-1XxxR-LF  
 LEADFREE

RoHS Compliant

RECOMMENDED P.C.B LAYOUT

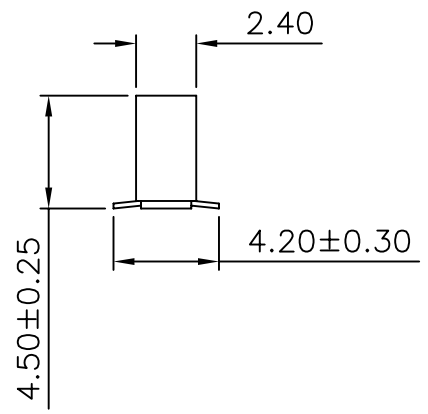
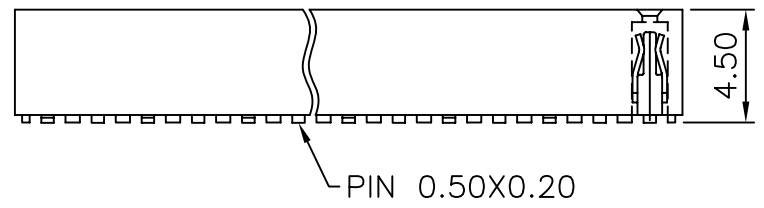
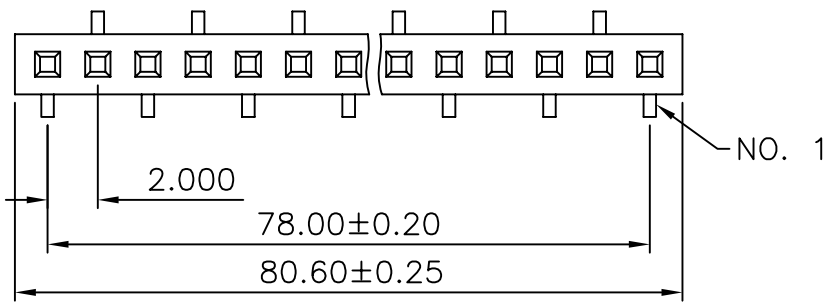
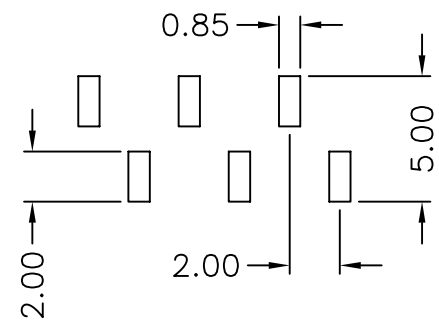

PART NO. S-V45X-1XxxR

DWG NO. S-V45X-1XxxR

FILE NO.

UNIT / mm

SCALE 1:1

CHECKED BY CY

DRAWING BY

PROJECTION

TOLERANCES ARE  
 .X ± 0.2  
 .XX ±  
 .XXX ±  
 AWG

DESCRIPTION:

2.00 FEMALE HEADER SINGLE ROW SMT TYPE  
 BASE 4.30H

AREA

REVISIONS

HK

DATE

煜倫股份有限公司