

SEC:A-A

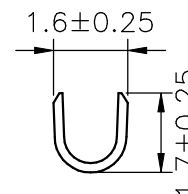

SEC:B-B

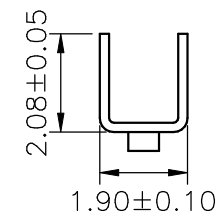

SEC:C-C

Ordering Information & Specifications

Part No	Wire Range	Insulation O.D.	Material	Finish	Qty/reel
BH-M-22	AWG#22-#28	2.40mm(max)	Phosphor Bronze	Tin-plated	5,000pcs

Note:E-Stamping before Tin-plated

BH-M-22-LF
LEADFREE
RoHS Compliant



PART NO. **BH-M-22**

DWG NO. **BH-M-22**

CHECKED BY CY

TOLERANCES ARE

DESCRIPTION:

4.00mm PITCH
CRIMP TERMINAL-MALE

FILE NO.

DRAWING BY

.X ± 0.2
.XX ±
.XXX ±
AWG

AREA

REVISIONS

HK

DATE

煜倫股份有限公司

UNIT / mm

SCALE 1:1

PROJECTION

