

**PCB LAYOUT**  
(Top View)

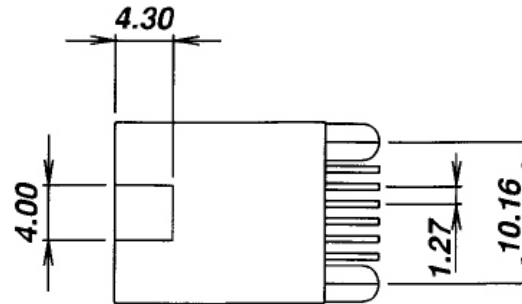

**SPECIFICATION :**

**1. Electrical Char.**

- Insulation Resistance : 500M-Ohm Min.*
- Contact Resistance : 20milli-Ohm Max.*
- Rating Current : 1.5A Max.*
- Rating Voltage : 120V AC*
- Dielectric Voltage : 1,000 Vrms 60 Sec. Min.*

**2. Physical char.**

- Housing : PBT Glass Filled (UL 94V-0)*
- Color : Black Color*
- Spring Wire : 0.45mm Dia. Phosphor Bronz*
- Gold Plating Over Nickel*
- Temperature Range : - 25 /+90 Deg C*
- Durability : 500 Mating cycles Min.*

MJDS12-KX06-06xx

- 02:02 CKT
- 04:04 CKT
- 06:06 CKT



PART NO. MJDS12-KX06-06xx

DWG NO. MJDS12-KX06-06xx

CHECKED BY CY

TOLERANCES ARE

DESCRIP TION:

FILE NO.

DRAWING BY

.X ± 0.2  
.XX ±  
.XXX ±  
AWG

AREA

REVISIONS

HK

DATE

煜倫股份有限公司

UNIT / mm

SCALE 1:1

PROJECTION

