

PCB Layout For Surface Mounting

Electrical:

1. Voltage : 50V.
2. Current : 0.5A.
3. Contact Resistance : 40m Ω max.
4. Dielectric Withstanding Voltage : 500V AC / 1 min.
5. Insulation Resistance : 100M Ω min.

RoHS Compliant

TOLERANCES ARE

MORETHANALL
PCB CONNECTORS
Cable ASSEMBLIES

DRAWING BY CY

CHECKED BY GENIUS

UNIT/ mm

SCALE 1 : 1

DATE

SIZE A4

X. ±
.X ±
.XX ±
.XXX ±
ANG ±

PJECTION

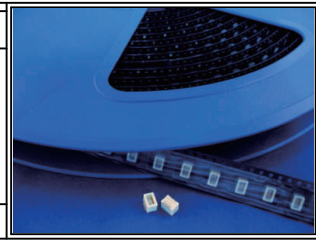

ORDER INFORMATION

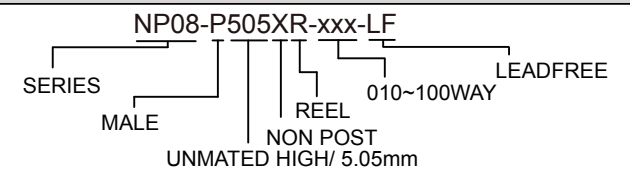

煜倫股份有限公司

www.morethanall.com

DESCRIPTION: 0.80mm (0.031") Pitch Board To Board
Female connector H = 5.05mm(NO BOSS)

DEVICE TYPE: NP08-P

CUSTOMER :

DWG NO :

MATERIAL :PS 黑色

Q'TY : 1000PCS/REEL

ITEM	W	A0	B0	K0	K1	-	-	-	-	-	-	-
DIM	16 ^{+0.3} _{-0.3}	4.5 ^{+0.1} _{-0.1}	7.2 ^{+0.1} _{-0.1}	6.35 ^{+0.1} _{-0.1}	5.45 ^{+0.1} _{-0.1}	-	-	-	-	-	-	-

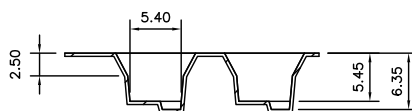
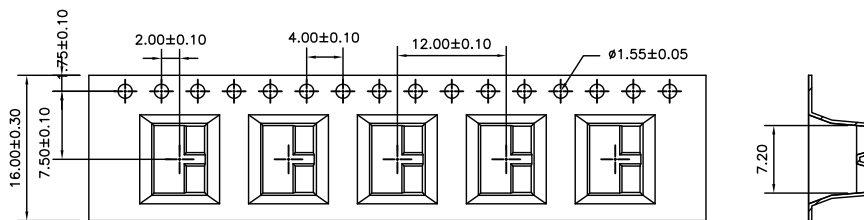

MORETHANALL
PCB CONNECTORS
Cable ASSEMBLIES

煜倫股份有限公司

www.morethanall.com

RoHS Compliant

DRAWING BY CY

CHECKED BY GENIUS

UNIT / mm

SCALE 1 : 1

DATE

SIZE A4

TOLERANCES ARE

X. ±
.X ±
.XX ±
.XXX ±
ANG ±

PJECTION

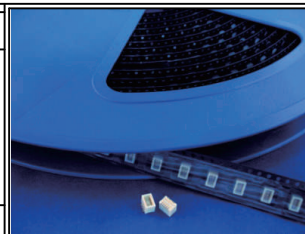

ORDER INFORMATION

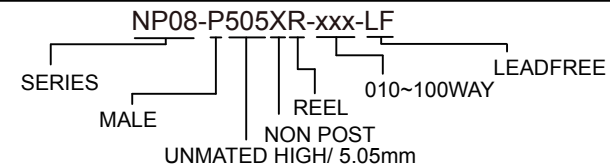

DESCRIPTION: 0.8mm Pitch Board-to-Board 2*5(10P) male Tape&Reel