

PCB LAYOUT COMPONENT SIDE

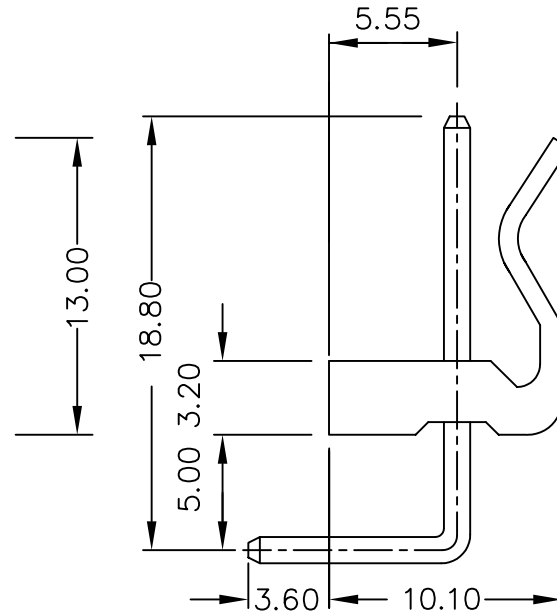
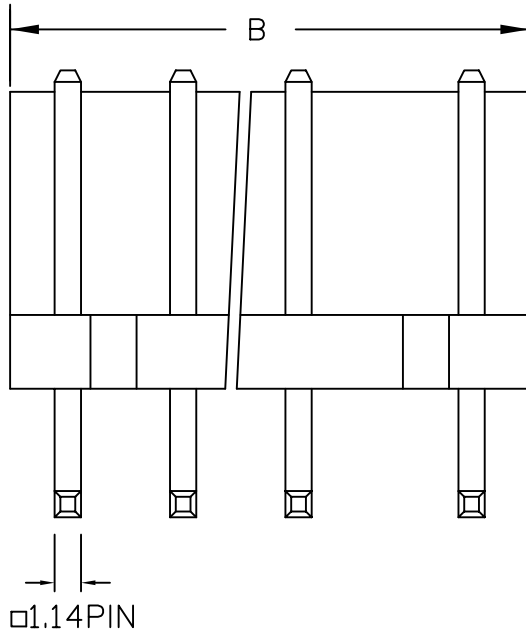

SPECIFICATIONS

Electrical

Current Rating: 5A AC, DC

Voltage Rating: 250V AC, DC

Operating Temp.: -25°C ~ +85°C

Insulation Resistance: 1000MΩ / min.

Dielectric Withstanding Voltage: 1500V AC / min.

Contact Resistance: 10mΩ / max.

Material

Material: Nylon66, UL94V-2

Poles	Dimension mm (in.)		Part No.	Note.
	A	B		
2	7.50	12.40	VK-R-02	
3	12.50	17.40	VK-R-03	
4	17.50	22.40	VK-R-04	
5	22.50	27.40	VK-R-05	
6	27.50	32.40	VK-R-06	
7	32.50	37.40	VK-R-07	

RoHS Compliant

TOLERANCES ARE

MORETHANALL
PCB CONNECTORS
Cable ASSEMBLIES

煜倫股份有限公司

www.morethanall.com

DRAWING BY CY

CHECKED BY GENIUS

UNIT / mm

SCALE 1 : 1

DATE

SIZE A4

PJECTION

X, ±
X ± 0.50
.XX ± 0.10
.XXX ±
ANG ±

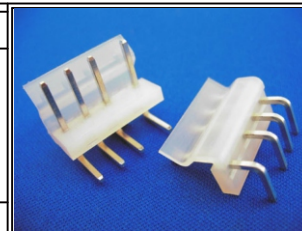

ORDER INFORMATION

VK-R-xx-LF
SERIES | LEADFREE
02-07 WAY
DIP 90°

DESCRIPTION: 7.5/5.0mm Wire-to-Board Header Dip 90° Type