

SPECIFICATION:

A=SL002

B=MATERIAL: Spring Brass  
Thickness: 0.4t

C=Fuse  $\varnothing 5 \times 20$ mm 250V AC 10A Max

D=Bright Tin-Plated, Nickel-Plated

E=P.C. Board Type with Fuse Stops

FSC-D-5X20-LF

LEADFREE

RoHS Compliant

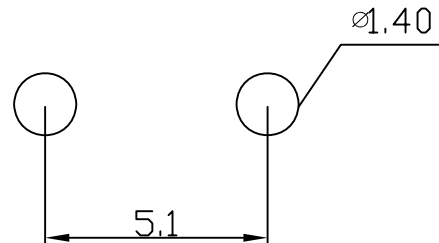
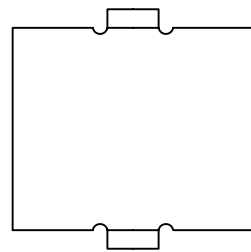

**MORETHANALL**  
CONNECTORS  
ASSEMBLIES

PART NO. FSC-D-5X20

DWG NO. FSC-D-5X20

FILE NO.

UNIT / mm

SCALE 1:1

CHECKED BY CY

DRAWING BY

PROJECTION

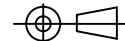

TOLERANCES ARE

.X  $\pm$  0.2

.XX  $\pm$

.XXX  $\pm$

AWG

DESCRIPTION:

AREA

REVISIONS

HK

DATE

焯倫股份有限公司