

Current Rating: 2.5A/10A(UL) / 2.5A(VDE)
 Voltage Rating: 250V(UL) / 250V(VDE)
 Soldering: Brass, Matte-Tin Plated
 Contact: Brass, Nickel Plated
 Body Insulator: PA66

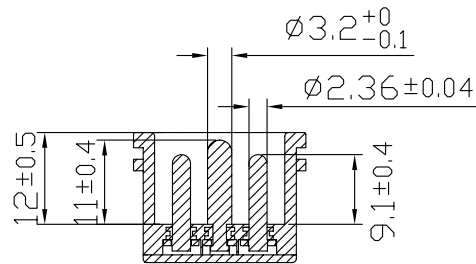

SECTION A-A

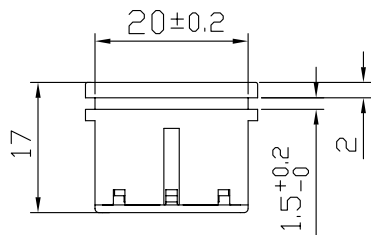
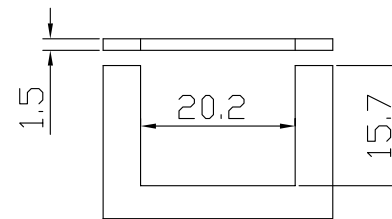

PANEL CUT-OUT

RoHS Compliant

TOLERANCES ARE

MORETHANALL
 PCB CONNECTORS
 Cable ASSEMBLIES

煜倫股份有限公司

www.morethanall.com

DRAWING BY CY

CHECKED BY GENIUS

UNIT / mm

SCALE 1 : 1

DATE

SIZE A4

P PROJECTION

X, ±

.X ±

.XX ±

.XXX ±

ANG ±

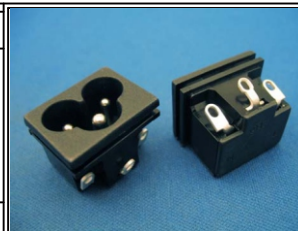

ORDER INFORMATION

ACR-PSPC-03-LF
 SERIES | | | | LEADFREE
 | | | | 03 WAY
 | | | | C TYPE
 | | | | PANEL
 | | | | SOLDER
 | | | | MALE

DESCRIPTION: