

1 2 3 4 5 6 7 8 9 0

J

I

H

G

F

E

D

C

B

A

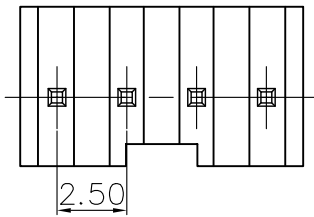
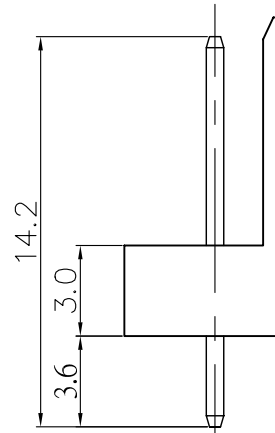
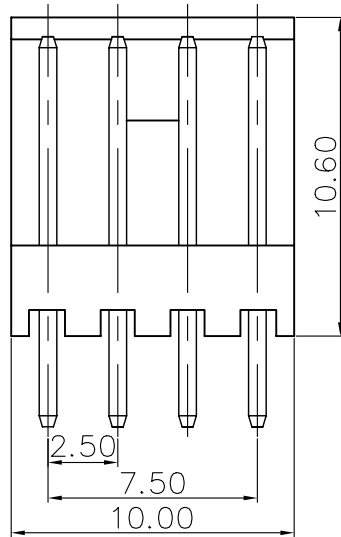
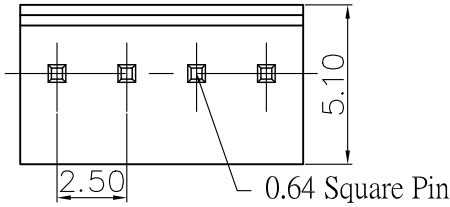

SPECIFICATIONS

Electrical

Current Rating: 2A AC, DC
 Voltage Rating: 100V AC/ max.
 Operating Temp.: -25°C ~ +85°C
 Insulation Resistance: 1000MΩ/ min.
 Withstand Voltage: 800V AC/ min.
 Contact Resistance: 20MΩ/ max.

Material

Terminal Material: Tin/ Gold Plated
 Material: Nylon 66, UL94V-0

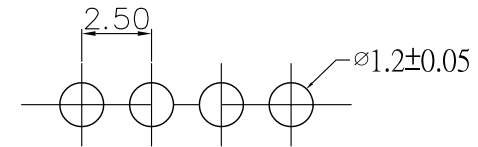

RECOMMENDED P.C.BOARD HOLE DIMM.



PART NO. EI-D-04

DWG NO. EI-D-04

FILE NO.

APPROVED BY CY

DRAWING BY

TOLERANCES ARE

.X
 .XX
 .XXX
 AWG

DESCRIPTION:

煜倫股份有限公司

UNIT / mm

SCALE 1:1

PROJECTION

AREA

REVISIONS

HK

DATE