

P.C.Board Layout

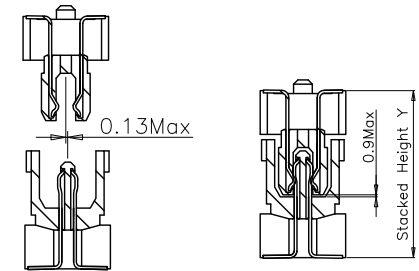
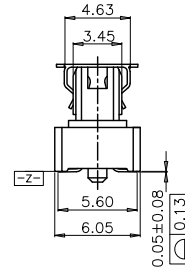
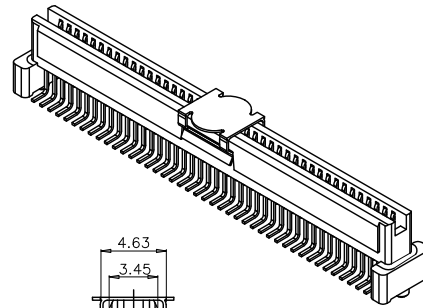

Material:

Housing: :High Temperature Plastic UL94V-0.
 Contacts: Phosphor Bronze.
 Pad: Metal.

Electrical Characteristics:

Current Rating: 0.5 AMP.
 Dielectric Withstanding Voltage: AC 500V For 1 minute.
 Insulator Resistance: 100MΩ min. at DC 100V.
 Contact Resistance: 40mΩ max. at DC 1mA.
 Operating Temperature: -40°C~+105°C .

***RoHS Compliant**

Position	14 Thru 100							
Dimension								
code:1~4 X	1	1	2	3	3	4	4	4
NP10-SxxxP	5.37	5.37	7.37	8.37	8.37	10.37	10.37	10.37
code:1~3 X	1	2	1	1	2	1	2	3
NP10-PxxxP	6.35	7.35	6.35	6.35	7.35	6.35	7.35	8.35
stacked height Y	8.0	9.0	10.0	11.0	12.0	13.0	14.0	15.0

RoHS Compliant

TOLERANCES ARE

X, ±
 .X ±
 .XX ±
 .XXX ±
 ANG ±

DRAWING BY CY

CHECKED BY GENIUS

UNIT/ mm SCALE 1:1

DATE

SIZE A4

PJECTION

MORETHANALL
PCB CONNECTORS
Cable ASSEMBLIES

煜倫股份有限公司

www.morethanall.com

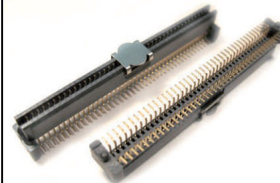

ORDER INFORMATION

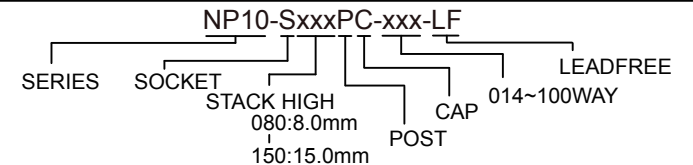

DESCRIPTION: