

MSB-SWFEEC-5AB-LF
LEADFREE
RoHS Compliant

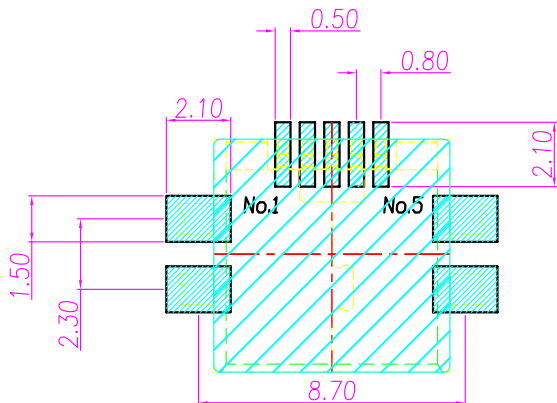

Recommend P.C.B LAYOUT

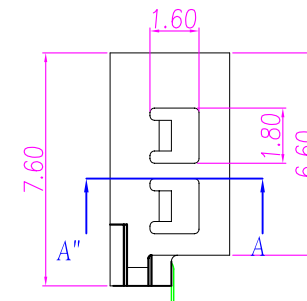
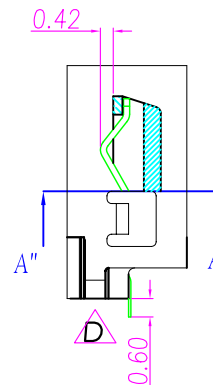
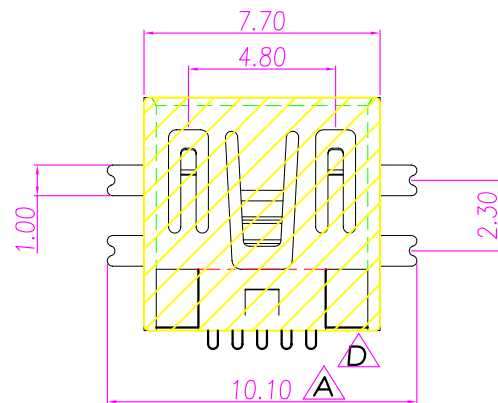
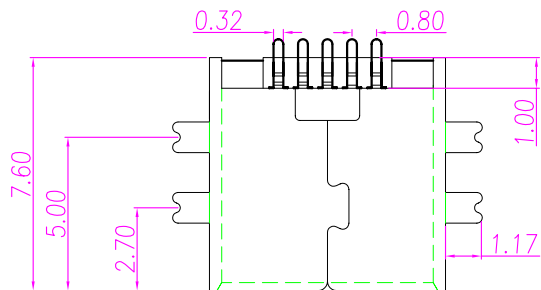
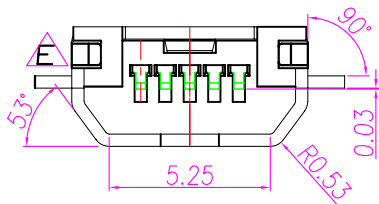

備註 /NOTE:

- 安規
 - 規格 /RATING: 5V / 1A
 - 絕緣阻抗 /Insulation Resistance: 100M ohm Min at DC 500V
 - 絕緣耐壓 /Dielectric Withstanding Voltage: AC 100V for 1 Minute
 - 接觸阻抗 /Contact Resistance: 30m ohm or less
- 材質 /MATERIAL:
 - 膠芯 /Housing: LCP Δ B
 - 針 /Pin: 磷銅 /PHOSPHOR BRONZE
 - 銅殼 /Shell: 黃銅 /BRASS Δ B
- 電鍍 /electroplate
 - 針 /Pin: 金10u" /GOLD 10u", 霧錫 /TIN
 - 銅殼 /Shell: 60u" /NI 60u"

MORETHANALL
CONNECTORS
ASSEMBLIES

煜倫股份有限公司

PART NO. MSB-SWFEEC-5AB

DWG NO. MSB-SWFEEC-5AB

FILE NO.

UNIT / mm

SCALE 1:1

CHECKED BY CY

DRAWING BY

PROJECTION

TOLERANCES ARE

.X ± 0.2
.XX ± 0.1
.XXX ±
AWG

DESCRIP TION: Mini Usb 5Pin 沉式 SMT

AREA

REVISIONS

HK

DATE