

US JACK 1
8P8C

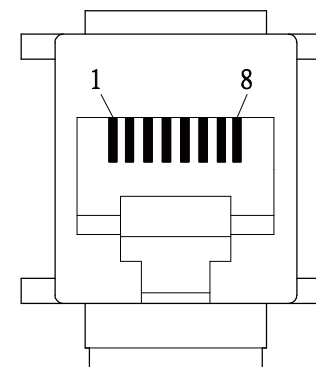
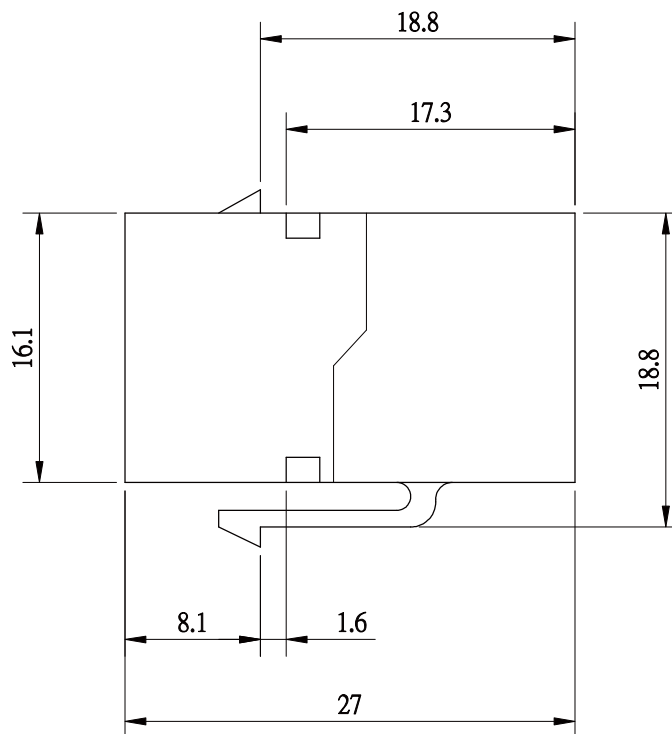

US JACK 2
8P8C

US JACK 1
8P8C

- | | |
|---|-------|
| 1 | _____ |
| 2 | _____ |
| 3 | _____ |
| 4 | _____ |
| 5 | _____ |
| 6 | _____ |
| 7 | _____ |
| 8 | _____ |

US JACK 2
8P8C

- | |
|---|
| 1 |
| 2 |
| 3 |
| 4 |
| 5 |
| 6 |
| 7 |
| 8 |

顏色: 黑色

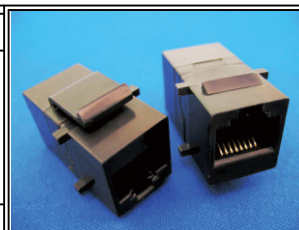
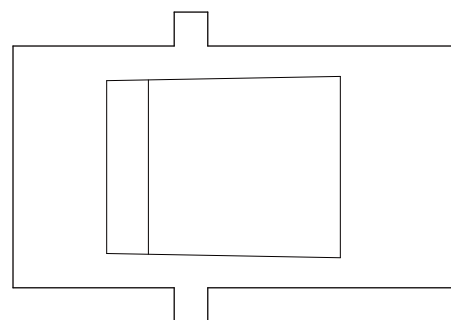

RoHS Compliant

TOLERANCES ARE

X, ±
.X ±
.XX ±
.XXX ±
ANG ±

DRAWING BY CY

CHECKED BY GENIUS

UNIT / mm SCALE 1 : 1

DATE

SIZE A4 PPROJECTION

ORDER INFORMATION

RJX2-FSPN-0808-LF

SERIES LEADFREE

6P4C

PANEL

FEMALE TO FEMALE 180°

MORETHANALL
PCB CONNECTORS
Cable ASSEMBLIES

煜倫股份有限公司

www.morethanall.com

DESCRIPTION: MODULAR COUPLER JACK UNSHIELDED (8P8C)