

A-A SECTION

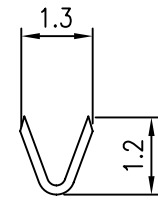

B-B SECTION

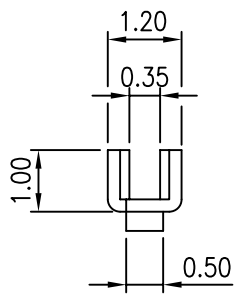
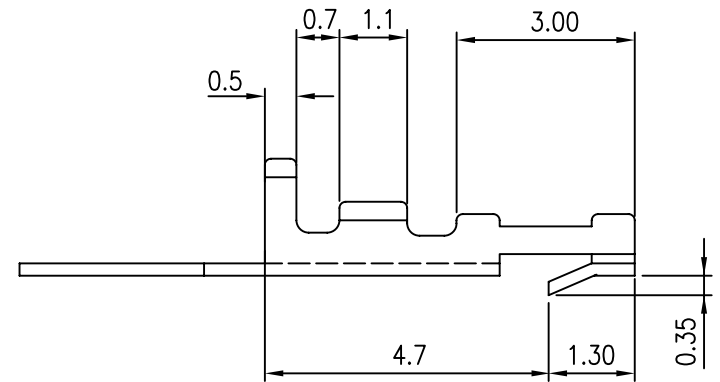

MV-T-26-LF
LEADFREE

RoHS Compliant

PART NO.	PLATING
MV-T-26-LF	TIN
MV-TG-26-LF	GOLD

■ **TERMINAL**

- Material: Brass
- Thickness: 0.2mm
- Plating: Gold, Tin
- Wire Range: Suitable for AWG#26~30
- Insulation O.D: 1.35mm(max)
- Q'TY: 10,000 pcs/roll



PART NO. MV-T-26

DWG NO. MV-T-26

FILE NO.

UNIT / mm

SCALE 1:1

CHECKED BY CY

DRAWING BY

PROJECTION

TOLERANCES ARE

.X ± 0.2
.XX ±
.XXX ±
AWG

DESCRIPTION:

2.00mm Pitch Terminal

AREA

REVISIONS

HK

DATE

煜倫股份有限公司