

Material:

1. Insulator: PBT+30% Glass Fiber(Meet UL94V-0).
2. Contact: Copper Alloy.
3. Contact Plated: Selective Gold over Nickel Plated.
4. Shell: Steel with Nickel or Tin or Zinc Plated.

Specification:

1. Current Rating: 5 Amps.
2. Withstanding Voltage: AC 500V for 1 Minute.
3. Insulation Resistance: 1000MΩ Min. at DC 500V.
4. Contact Resistance: 15mΩ Max..
5. Operating Temperature: -40°C~+105°C.

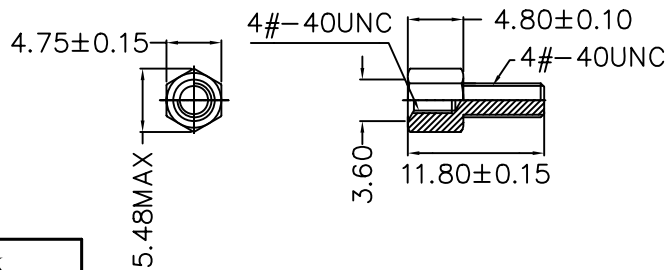
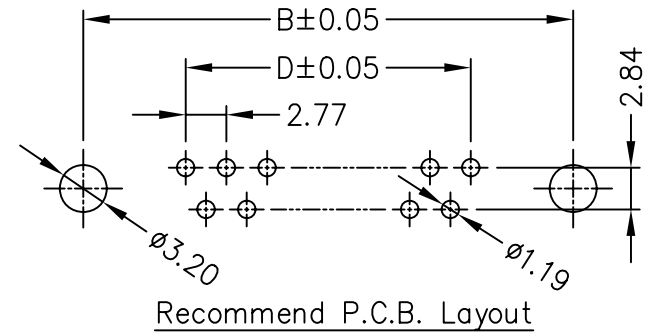
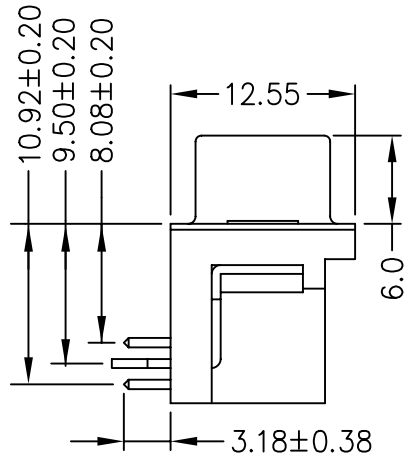
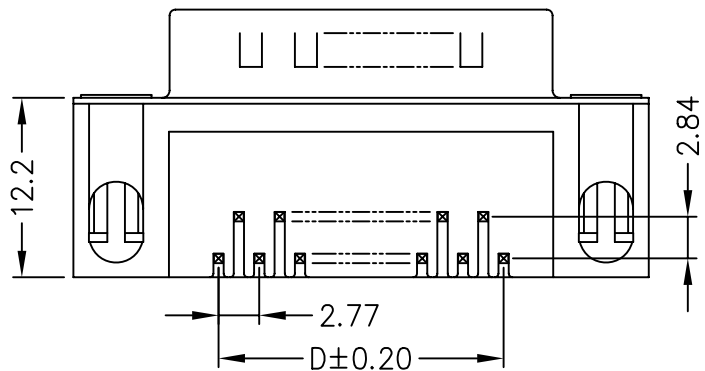

No. of Contacts	Dim. A	Dim. B	Dim. C	Dim. D
DR-PGNH-09	16.92	24.99	30.81	11.08
DR-PGNH-15	25.25	33.32	39.14	19.39
DR-PGNH-25	38.96	47.04	53.04	33.24
DR-PGNH-37	55.42	63.50	69.32	49.86



PART NO. DR-PGNH-xx

DWG NO. DR-PGNH-xx

FILE NO.

CHECKED BY CY

DRAWING BY

TOLERANCES ARE

.X ± 0.3
.XX ± 0.15
.XXX
AWG

DESCRIPTION: D-SUB RIGHT ANGLE MALE CONNECTOR
8.08mm WITH RIVET TYPE

煜倫股份有限公司

UNIT / mm

SCALE 1:1

PROJECTION



AREA	REVISIONS	HK	DATE
------	-----------	----	------