

MATERIAL:
 · HOUSING—DSM STANYL TE250F6 (NYLON-46)
 HEAT DEFLECTION TEMP.290°
 BLACK COLOR, UL94V-0
 · CONTACTS—0.35mm THICK PHOS-BRONZE PLATED
 WITH HARD GOLD AND GOLD FLASH IN
 SOLDER AREA.
 CAVITY CONFIRMS TO FCC RULES AND REGULATIONS
 PART 68,SUBPART F.

MJ13U-KX06-0808-LF
 LEADFREE

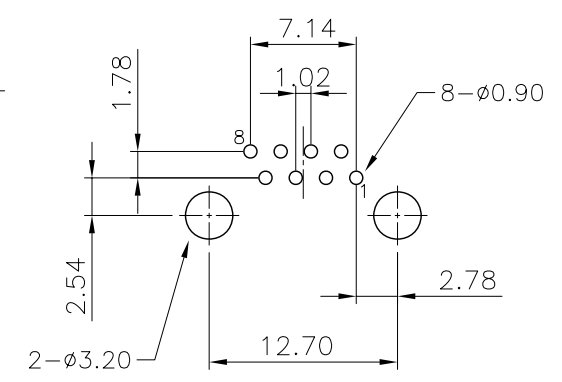
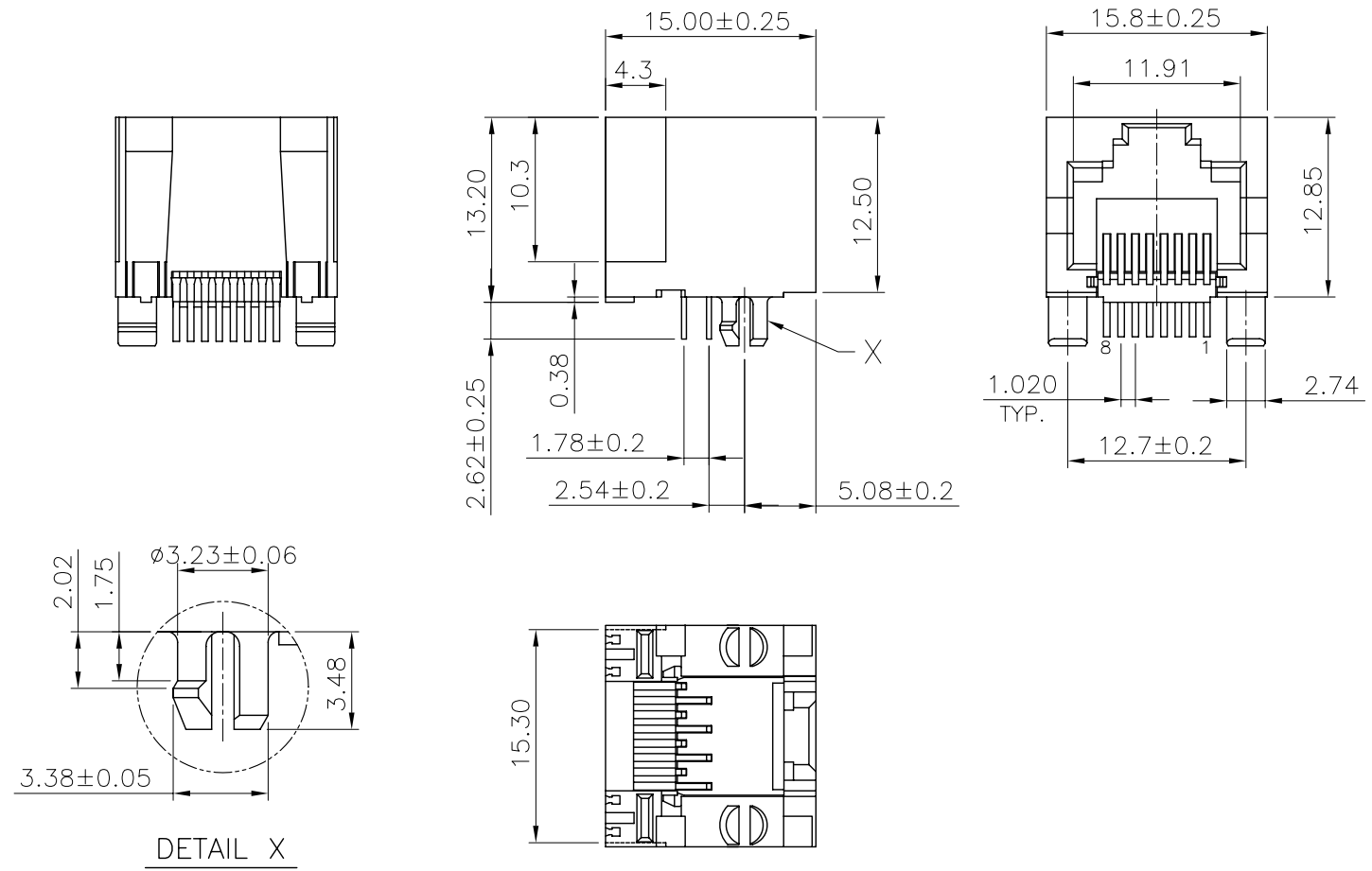

PCB LAYOUT (TOP VIEW)
 RECOMMENDED

RoHS Compliance

MORETHANALL
 CONNECTORS
 ASSEMBLIES

PART NO. MJ13U-KX06-0808

DWG NO. MJ13U-KX06-0808

CHECKED BY CY

TOLERANCES ARE

DESCRIPTION:

RJ45, W/O LED
 FLAT PIN, SIDE ENTRY JACK

煜倫股份有限公司

FILE NO.

DRAWING BY

.X ± 0.2
 .XX ±
 .XXX ±
 AWG

AREA

REVISIONS

HK

DATE

UNIT / mm

SCALE 1:1

PROJECTION