

NOTES:

***Material**

Housing: Nylon46+30%G.F, UL 94V-0 Rated. Color: Black.
 Contact: Brass(C2680 H)
 Plating: Gold plating over Nickel on contact Area; Tin plating on solder tail.

***Mechanical**

Insertion Force: 1.15N max per contact pair;
 Withdrawal Force: 0.15N min per contact pair;
 Contact Retention Force: 4.9N min per contact;

***Electrical Specification**

Contact Resistance : 30 Milliohms Max.
 Current Resistance : 1.1 Ampere
 Insulation Resistance : 1000 Megohms Min, At 500V AC.

***Environmental**

Operating Temperature : -55°C to +105°C

PCIX-R-098-LF
 LEADFREE

RoHS Compliant

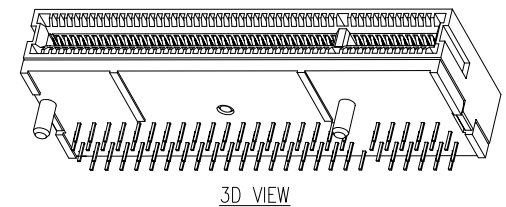
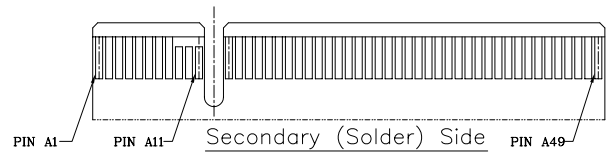
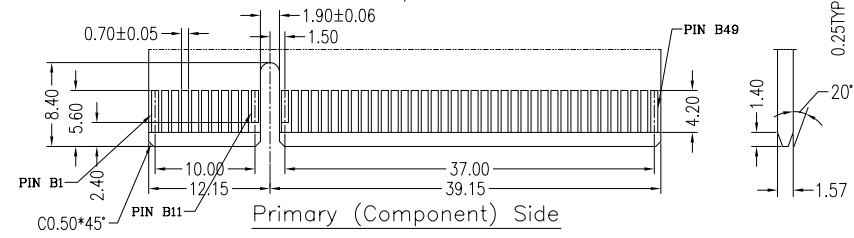
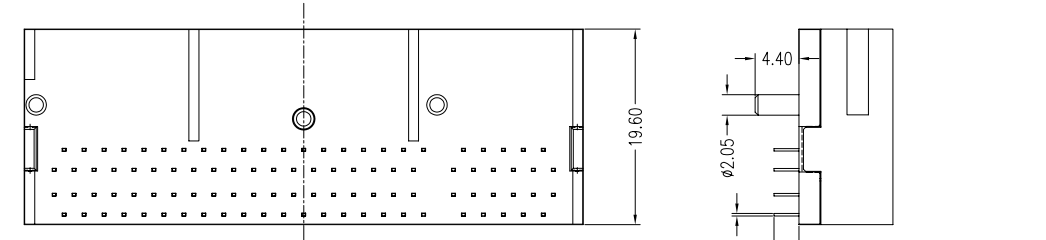
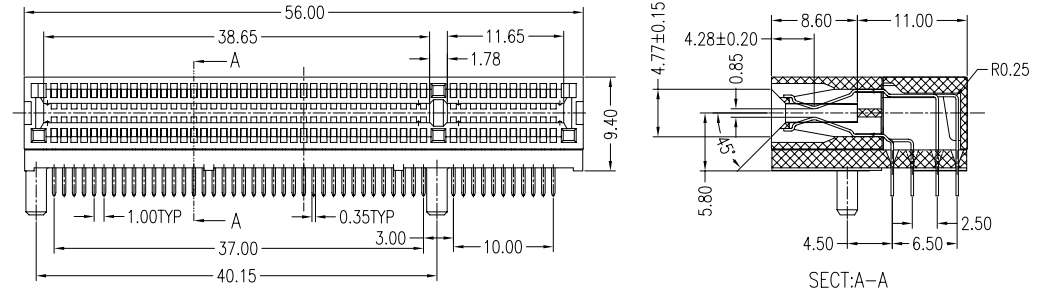
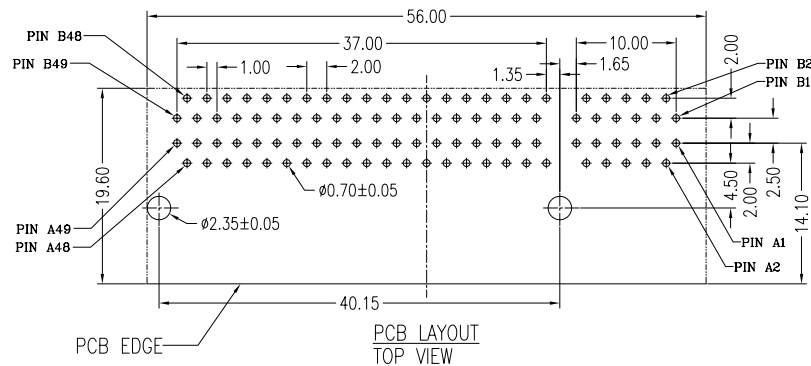

PART NO. PCIX-R-098

DWG NO. PCIX-R-098

FILE NO.

UNIT / mm

SCALE 1:1

CHECKED BY CY

DRAWING BY

PROJECTION

TOLERANCES ARE

.X ± 0.2
 .XX ± 0.1
 .XXX ±
 AWG

DESCRIP TION:		PCI EXPRESS R/A DIP TYPE 98P CRT		
AREA	REVISIONS	HK	DATE	

煜倫股份有限公司