

**MATERIAL**

Contact Pin : Brass

**SPECIFICATION**

Current Rate : 3 AMP

Insulation Resistance : 5000MΩMin. at DC 500V

Contact Resistance : 20mΩMax. at DC 100mA

Dielectric Voltage : AC 500V for one minute

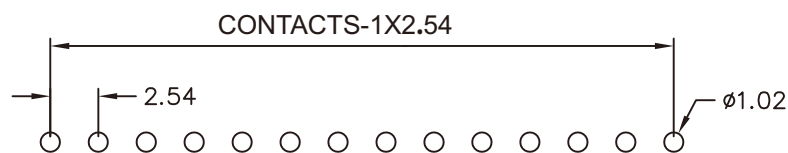
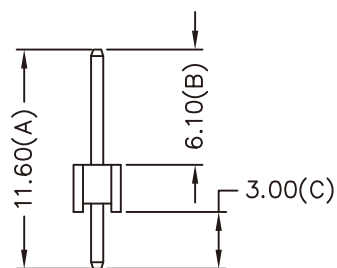
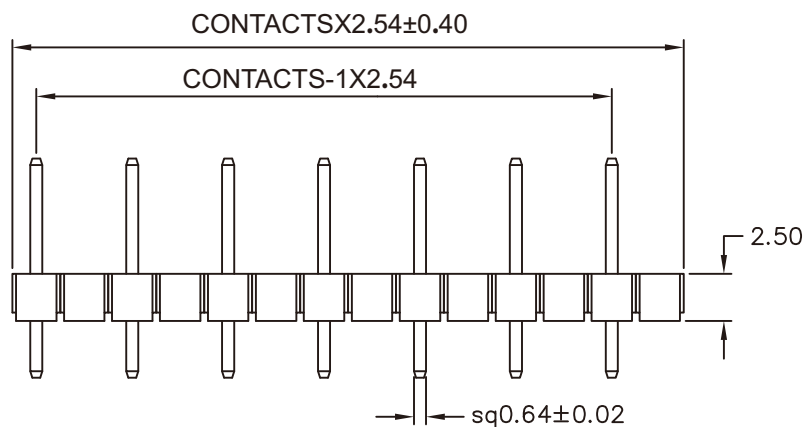

Recommended P.C.B Layout

**RoHS Compliant**

TOLERANCES ARE

**MORETHANALL**  
PCB CONNECTORS  
Cable ASSEMBLIES

DRAWING BY CY

X, ±

CHECKED BY GENIUS

.X ±

UNIT / mm

SCALE 1 : 1

.XX ±

DATE

.XXX ±

ANG ±

SIZE A4

PPOJECTION

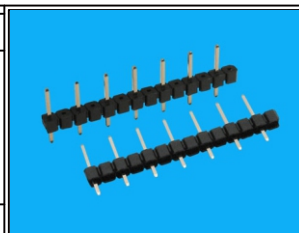

**ORDER INFORMATION**

H-DEE-1Xxx-LF

SERIES | LEADFREE

1X02:02WAY

1X25:25WAY

EMPTY EVEN PIN

DIP 180°

**煜倫股份有限公司**

www.morethanall.com

DESCRIPTION: PIN HEADER 2.54\*2.54mm STRAIGHT TYPE, SINGLE ROW