

• MATERIALS:(RoHS Compliant)

Hood: Plastic Thermoplastic ABS UL 94V-0
 Jackscrews: Steel Nickel Plated Over Copper
 Jackscrews Hood: PVC
 Inner Shell: Steel Nickel Plated Over Copper

• MATERIALS:(RoHS Compliant)

Housing: Plastic Thermoplastic
 P.B.T UL94V-0 Black
 Contacts: Phosphor Bronze Gold
 Selective Plated
 Front Shell: Steel Nickel Plated
 Over Copper

• ELECTRICAL CHARACTERISTICS:

Contact Current Rating: 1 Amp
 Dielectric Withstanding Voltage: 500V AC
 Insulation Resistance: >500MΩ/Min
 Contact Resistance: 35mΩ/Max
 Operation Temperature: -55°C ~ +105°C

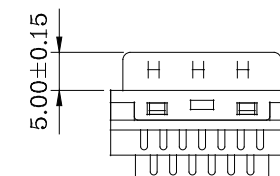
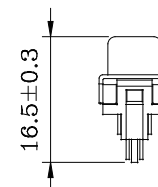
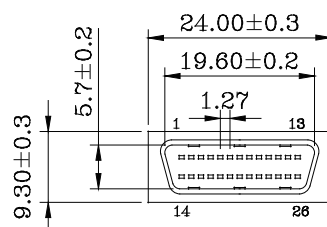
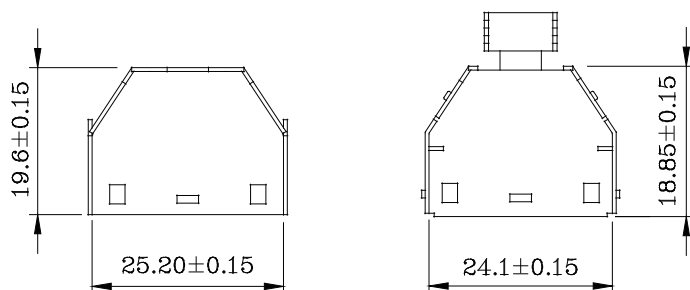
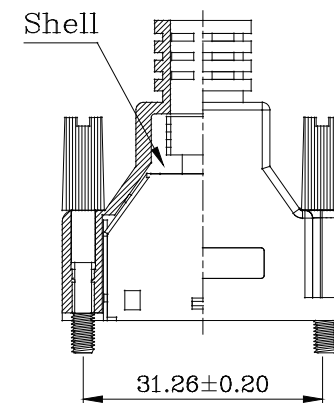
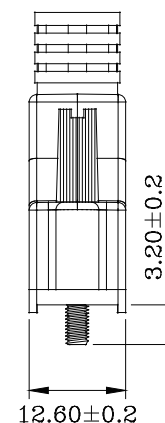
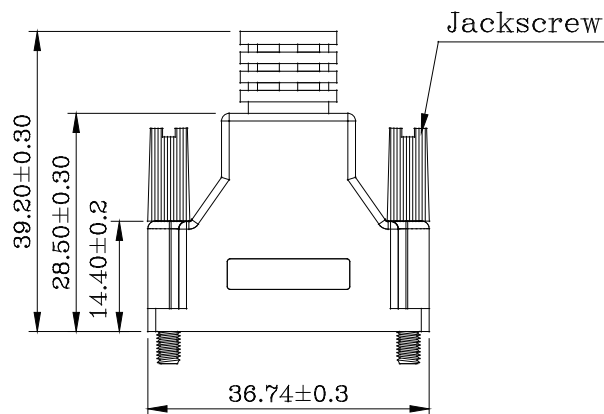
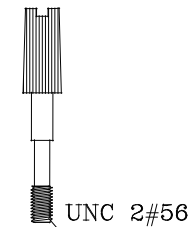
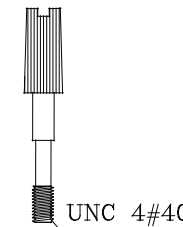
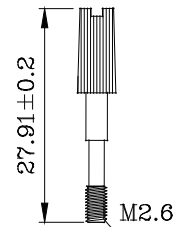
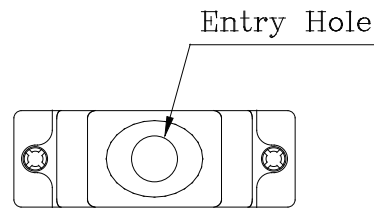

RoHS Compliant

TOLERANCES ARE

MORETHANALL
 PCB CONNECTORS
 Cable ASSEMBLIES

煜倫股份有限公司

www.morethanall.com

DRAWING BY CY

CHECKED BY GENIUS

UNIT/mm SCALE 1:1

DATE

SIZE A4

X. ±
 .X ±
 .XX ±
 .XXX ±
 ANG ±

PJECTION

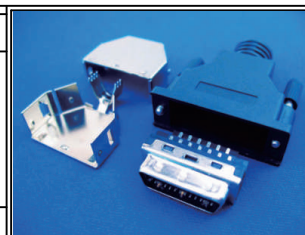

ORDER INFORMATION

HPD-PSMBK-026-LF
 SERIES | 26 WAY | LEADFREE
 BLACK COVER
 SOLDER
 MALE

DESCRIPTION: