

**SPECIFICATIONS**

Current Rating: 3 Amp  
 Voltage Rating: 250V  
 Insulator resistance: 5000 MΩ Min.  
 Contact Resistance: 20 mΩ Max.  
 Dielectric withstanding: AC 1000V/minute  
 Operating Temperature: -40° ~ +75°C

Contact Material: Brass  
 Insulator Material: Nylon-6T UL94V-0  
 Color: Natural  
 Finish: Tin plated

Cir- cuits	Dimension mm	
	L1	L2
2	2.54	5.08
3	5.08	7.62
4	7.62	10.16
5	10.16	12.70
6	12.70	15.24
7	15.24	17.78
8	17.78	20.32
9	20.32	22.86
10	22.86	25.40
11	25.40	27.59
12	27.59	30.48
13	30.48	33.02
14	33.02	35.56
15	35.56	38.10

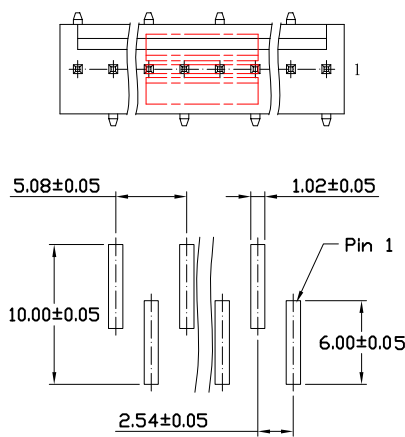
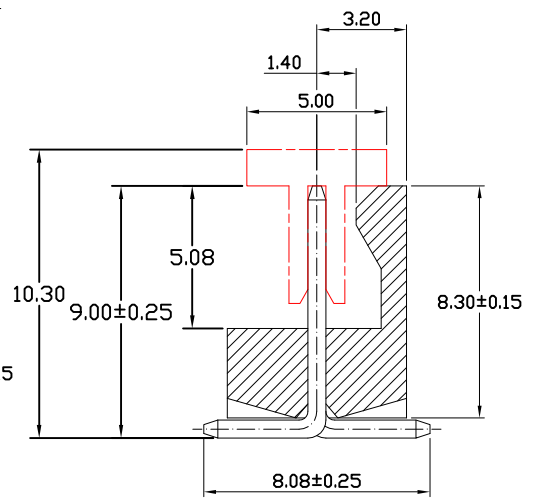
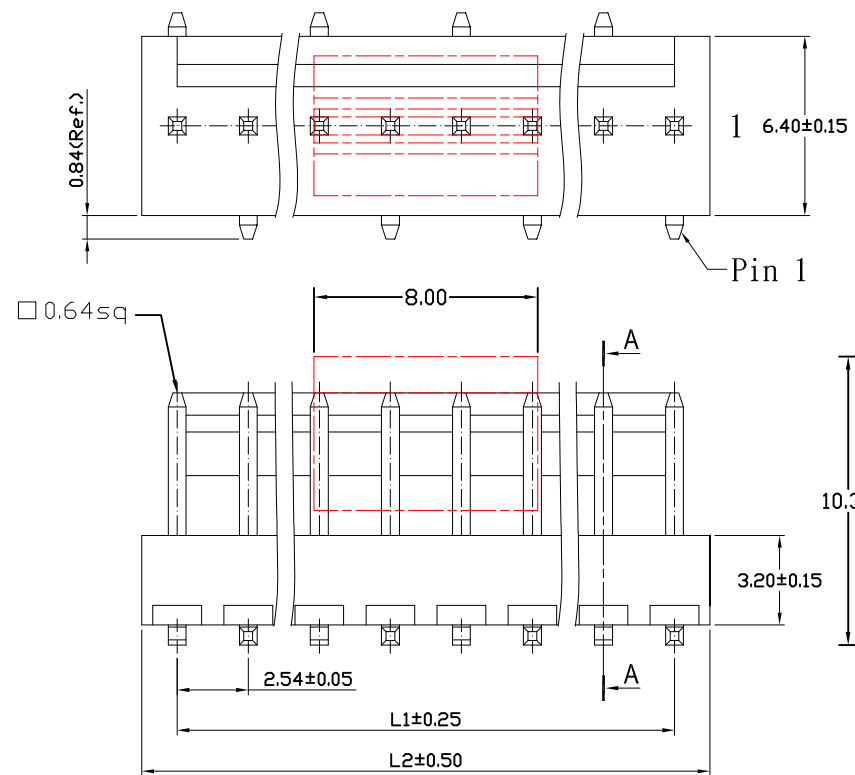

RECOMMENDED P. C. B. LAYOUT

**RoHS Compliant**

TOLERANCES ARE



DRAWING BY CY  
 CHECKED BY GENIUS  
 UNIT / mm SCALE 1 : 1  
 DATE  
 SIZE A4

X. ±  
 .X ±  
 .XX ±  
 .XXX ±  
 ANG ±



**ORDER INFORMATION**

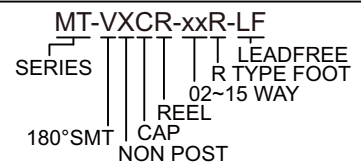

DESCRIPTION:

煜倫股份有限公司

www.morethanall.com

PJECTION

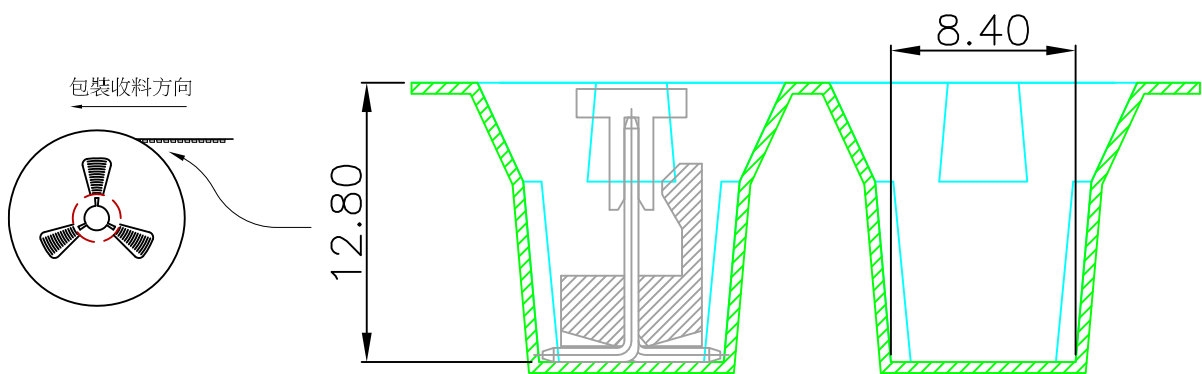
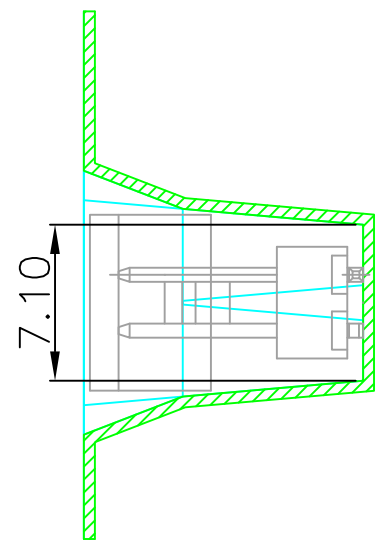
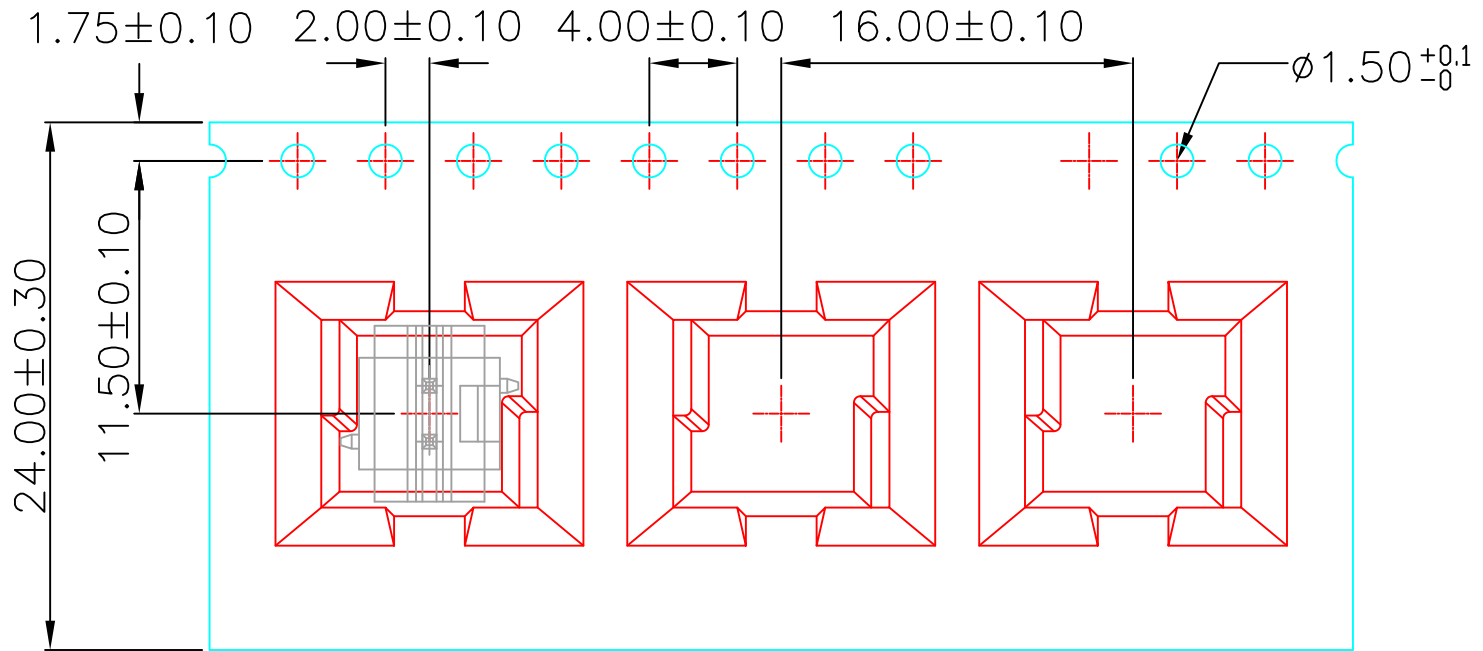

1. 10 sprocket hole pitch cumulative tolerance  $\pm 0.20$ .
2. Carrier camber is within 1 mm in 250 mm.
3. Material : Black Conductive Polystyrene Alloy.
4. All dimensions meet EIA-481-D requirements.
5. Thickness :  $0.50 \pm 0.05$  mm.
6. Packing length per 22" reel : 17.0 Meters.(1:3)
7. Component load per 13" reel : 300 pcs.

RoHS Compliant

TOLERANCES ARE

**MORETHANALL**  
PCB CONNECTORS  
Cable ASSEMBLIES  
煜倫股份有限公司  
www.morethanall.com

DRAWING BY CY		X. $\pm 0.30$
CHECKED BY GENIUS		.X $\pm 0.20$
UNIT / mm	SCALE 1 : 1	.XX $\pm 0.10$
DATE		.XXX $\pm$
SIZE A4	PJECTION	ANG $\pm 3^\circ$



ORDER INFORMATION

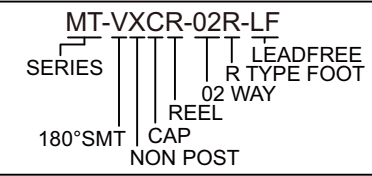

DESCRIPTION: 02 Pin REEL

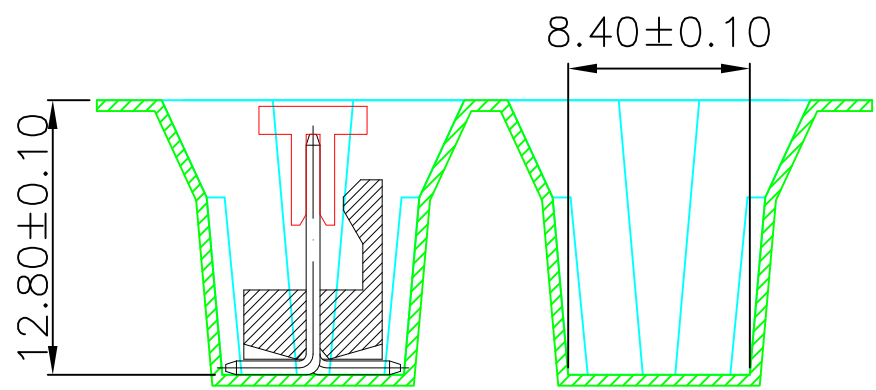
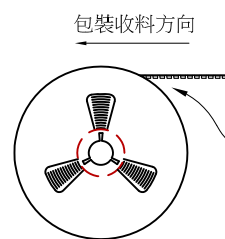
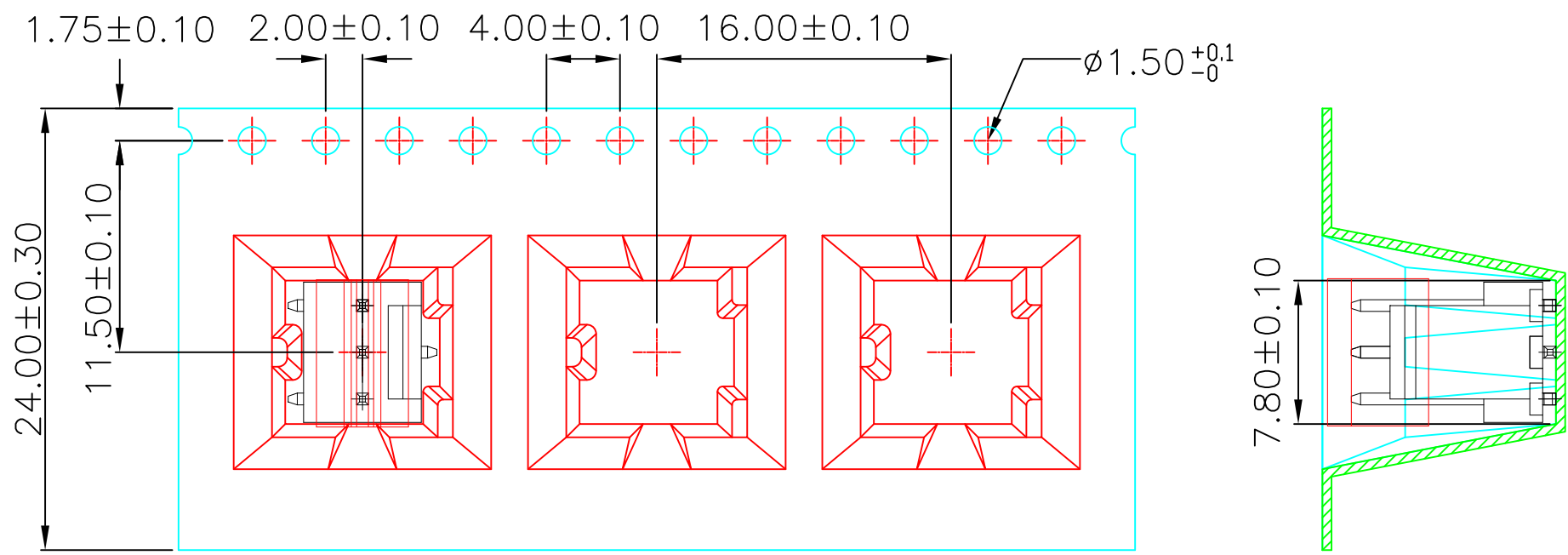

1. 10 sprocket hole pitch cumulative tolerance  $\pm 0.20$ .
2. Carrier camber is within 1 mm in 250 mm.
3. Material : Black Conductive Polystyrene Alloy.
4. All dimensions meet EIA-481-D requirements.
5. Thickness :  $0.50 \pm 0.05$ mm.
6. Packing length per 22" reel : 17.0 Meters.(1:3)
7. Component load per 13" reel : 300 pcs.

**RoHS Compliant**

TOLERANCES ARE

**MORETHANALL**  
PCB CONNECTORS  
Cable ASSEMBLIES

DRAWING BY CY

X,  $\pm$   
X  $\pm$  0.30

CHECKED BY GENIUS

.XX  $\pm$  0.20

UNIT / mm

SCALE 1 : 1

.XXX  $\pm$  0.10

DATE

ANG  $\pm$

**煜倫股份有限公司**

[www.morethanall.com](http://www.morethanall.com)

SIZE A4

PPOJECTION



**ORDER INFORMATION**

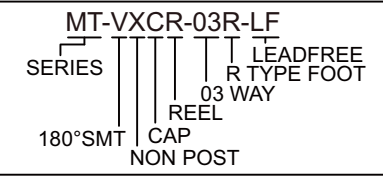

DESCRIPTION: 03 Pin REEL

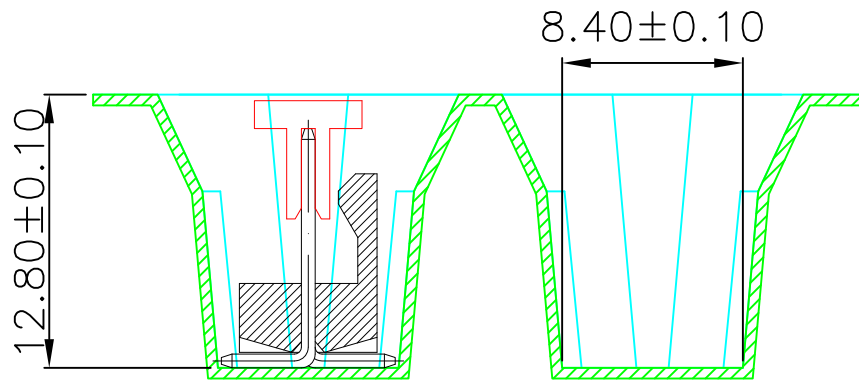
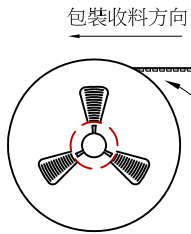
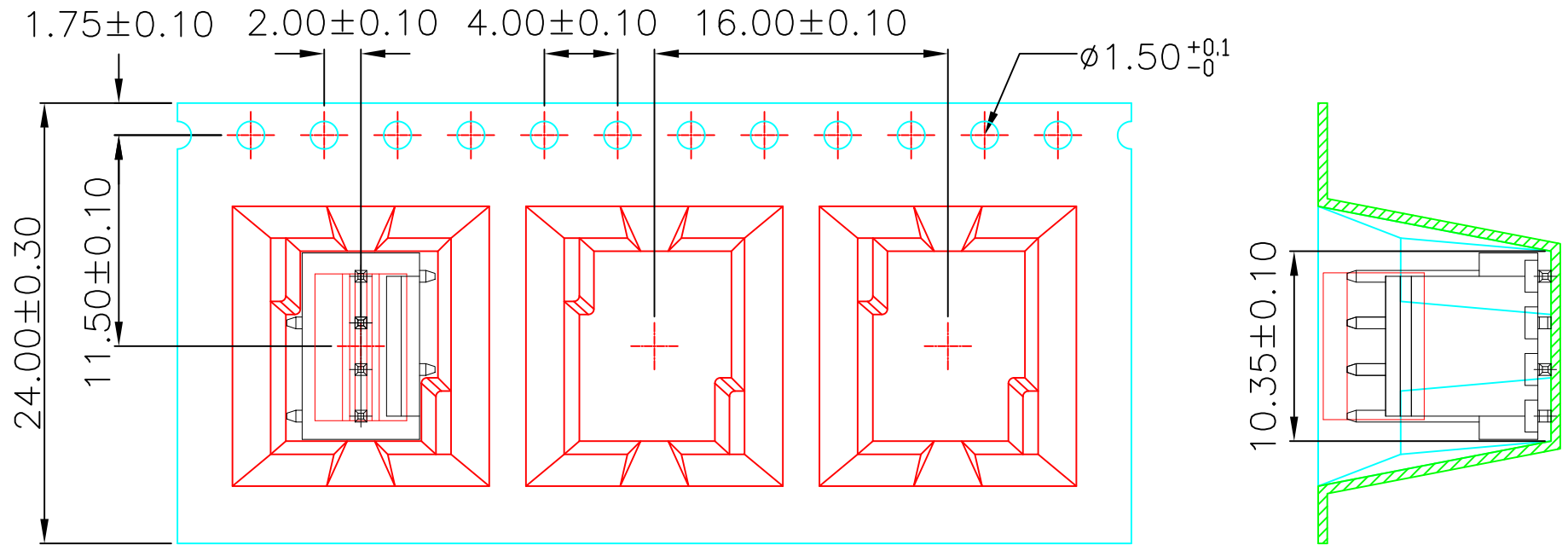

1. 10 sprocket hole pitch cumulative tolerance  $\pm 0.20$ .
2. Carrier camber is within 1 mm in 250 mm.
3. Material : Black Conductive Polystyrene Alloy.
4. All dimensions meet EIA-481-D requirements.
5. Thickness :  $0.50 \pm 0.05$  mm.
6. Packing length per 22" reel : 17.0 Meters.(1:3)
7. Component load per 13" reel : 300 pcs.

RoHS Compliant

TOLERANCES ARE

**MORETHANALL**  
PCB CONNECTORS  
Cable ASSEMBLIES

DRAWING BY CY

X.  $\pm 0.30$

CHECKED BY GENIUS

.X  $\pm 0.20$

UNIT / mm

SCALE 1 : 1

.XX  $\pm 0.10$

DATE

.XXX  $\pm$

ANG  $\pm 3^\circ$

SIZE A4

PJECTION



ORDER INFORMATION

MT-VXCR-04R-LF  
SERIES | | | | | LEADFREE  
R TYPE FOOT  
04 WAY  
REEL  
180°SMT | CAP | NON POST

煜倫股份有限公司

www.morethanall.com

DESCRIPTION: 04 Pin REEL

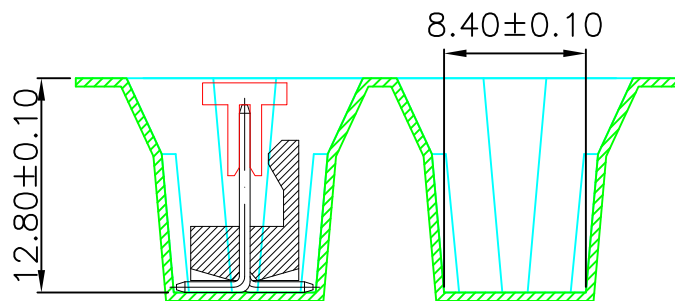
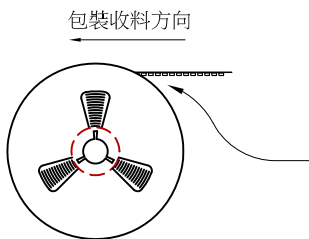
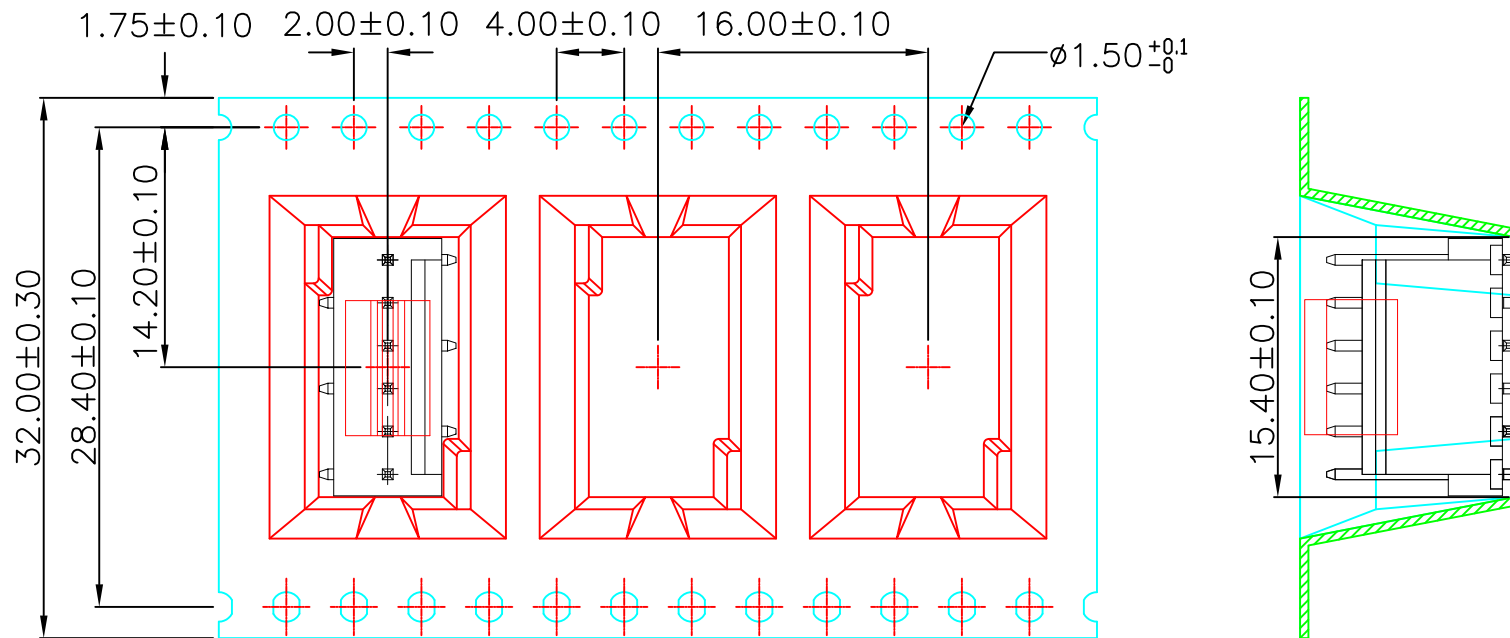

1. 10 sprocket hole pitch cumulative tolerance  $\pm 0.20$ .
2. Carrier camber is within 1 mm in 250 mm.
3. Material : Black Conductive Polystyrene Alloy.
4. All dimensions meet EIA-481-D requirements.
5. Thickness :  $0.50 \pm 0.05$  mm.
6. Packing length per 22" reel : 17.0 Meters.(1:3)
7. Component load per 13" reel : 300 pcs.

RoHS Compliant

TOLERANCES ARE

**MORETHANALL**  
PCB CONNECTORS  
Cable ASSEMBLIES

DRAWING BY CY

X.  $\pm 0.30$

CHECKED BY GENIUS

.X  $\pm 0.20$

UNIT / mm

SCALE 1 : 1

.XXX  $\pm$

DATE

ANG  $\pm 3^\circ$

SIZE A4

PJECTION



ORDER INFORMATION

MT-VXCR-06R-LF  
SERIES | REEL | LEADFREE  
R TYPE FOOT  
06 WAY  
180°SMT | CAP | NON POST

煜倫股份有限公司

www.morethanall.com

DESCRIPTION: 06 Pin REEL