

- NOTES:
- MATERIAL:
 - HOUSING: THERMOPLASTIC, HIGH TEMP., UL94V-0; COLOR:NATURAL.
 - CONTACT: COPPER ALLOY
 - FINISH:
 - GOLD FLASH PLATING(1~3u")
 - N:100~200u" MATT TIN PLATING
 - 50~100u" NICKEL UNDERPLATING OVERALL.
 - REFLOW SOLDER CAPABLE TO 260°C

FX8-P09PCR-xxx-LF
LEADFREE
RoHS Compliant

CKT	DimA	DimB	DimC	DimD	DimE
40	11.4	14.7	17.0	18.6	16.2
60	17.4	20.7	23.0	24.6	22.2
80	23.4	26.7	29.0	30.6	28.2
90	26.4	29.7	32.0	33.6	31.2
100	29.4	32.7	35.0	36.6	34.2
120	35.4	38.7	41.0	42.6	40.2
140	41.4	44.7	47.0	48.6	46.2
160	47.4	50.7	53.0	54.6	52.2

MORETHANALL
CONNECTORS
ASSEMBLIES

焯倫股份有限公司

PART NO. FX8-P09PCR-xxx		CHECKED BY CY		TOLERANCES ARE .X ± 0.2 .XX ± 0.1 .XXX ± AWG		DESCRIP TION: 0.6mm BTB PLUG SMT S/T D/R TYPE	
DWG NO. FX8-P09PCR-xxx		DRAWING BY					
FILE NO.		PROJECTION		AREA	REVISIONS	HK	DATE
UNIT / mm	SCALE 1:1						

1 2 3 4 5 6 7 8 9 0

J
I
H
G
F
E
D
C
B
A

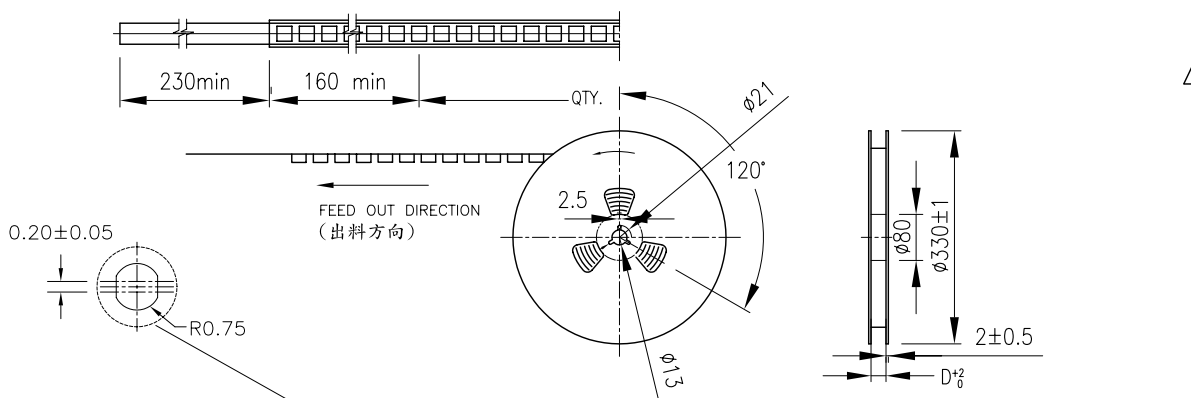

CKT.	A	B	C	D	E
40	14.20±0.10	19.00	32.00	32.40	28.40
60	20.20±0.15	25.00	44.00	44.40	40.40
80		31.00			
90	26.20±0.15	34.00	56.00	56.40	52.40
100		37.00			
120	34.20±0.30	43.00	72.00	72.40	68.40
140		49.00			
160	55.00				

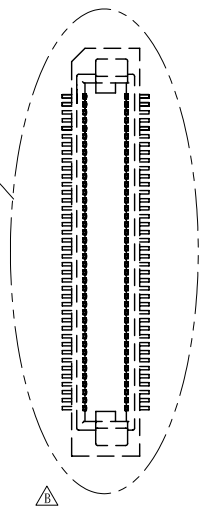
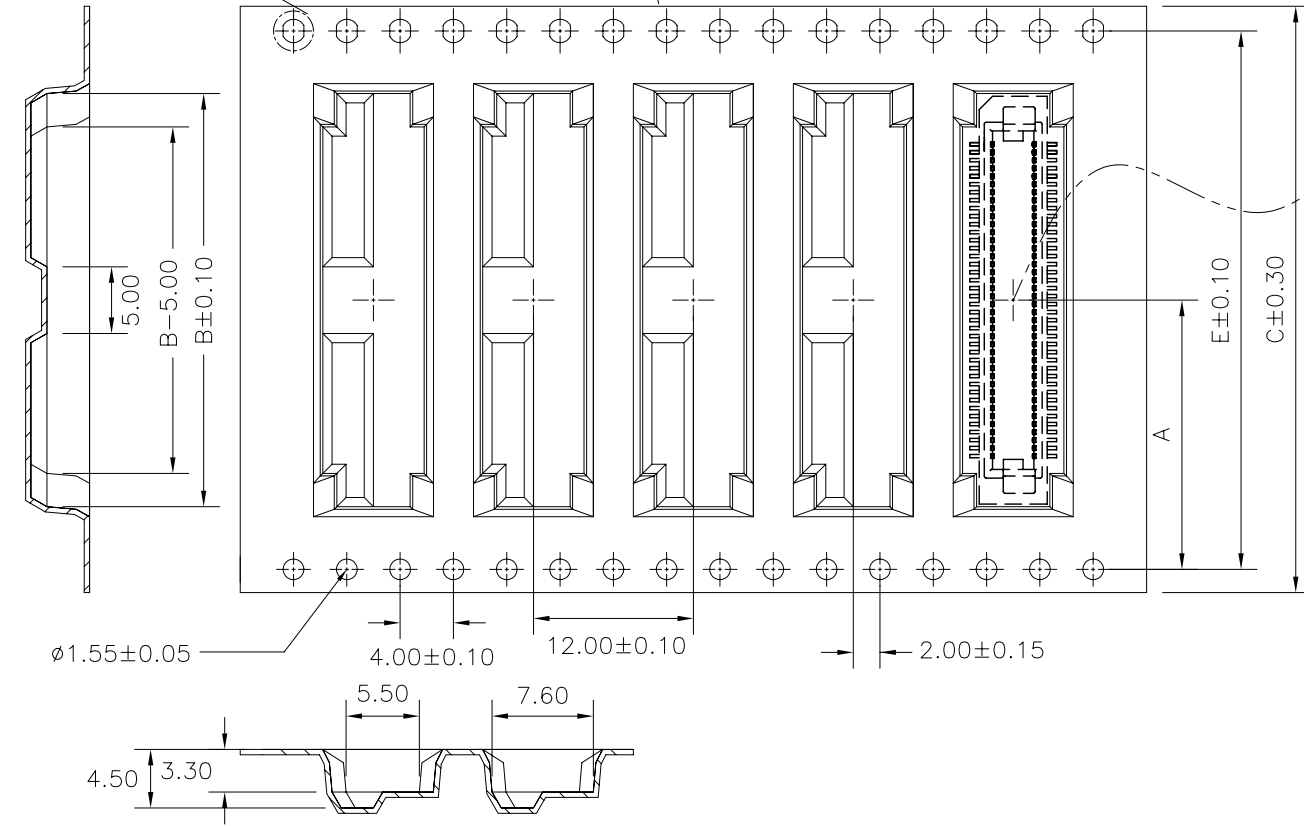

1. Thickness : 0.35±0.05mm.
2. Components load per 13" reel : 1000 pcs.

MORETHANALL
CONNECTORS
ASSEMBLIES

PART NO. FX8-P09PCR-xxx
DWG NO. FX8-P09PCR-xxx
FILE NO.
UNIT / mm SCALE 1:1

Rohs Compliant

CHECKED BY CY
DRAWING BY
PROJECTION

TOLERANCES ARE
.X ± 0.2
.XX ± 0.1
.XXX ± AWG

DESCRIPTION:	EMBOSSSED TAPE PACKING			
AREA	REVISIONS	HK	DATE	

煜倫股份有限公司