

**MATERIAL**

Contact Pin : Phosphor Bronze

**SPECIFICATION**

Current Rate : 0.75 AMP

Insulation Resistance : 5000MΩMin.

Contact Resistance : 15mΩMax.

Dielectric Voltage : AC 500V for one minute

Operation Temperature : -40°C to + 105°C

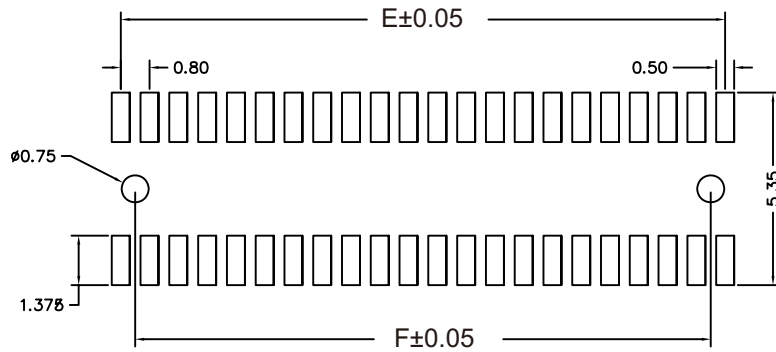
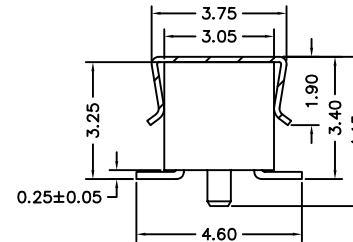
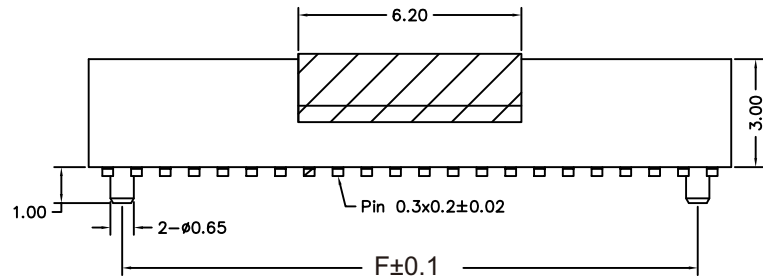

Recommended P.C.B Layout

POLES	DIM D	DIM E	DIM F	POLES	DIM D	DIM E	DIM F	POLES	DIM D	DIM E	DIM F
				19	15.46	14.40	13.60	36	29.06	28.00	27.20
3	2.66	1.60	0.80	20	16.26	15.20	14.40	37	29.86	28.80	28.00
4	3.46	2.40	1.60	21	17.06	16.00	15.20	38	30.66	29.60	28.80
5	4.26	3.20	2.40	22	17.86	16.80	16.00	39	31.46	30.40	29.60
6	5.06	4.00	3.20	23	18.66	17.60	16.80	40	32.26	31.20	30.40
7	5.86	4.80	4.00	24	19.46	18.40	17.60	41	33.06	32.00	31.20
8	6.66	5.60	4.80	25	20.26	19.20	18.40	42	33.86	32.80	32.00
9	7.46	6.40	5.60	26	21.06	20.00	19.20	43	34.66	33.60	32.80
10	8.26	7.20	6.40	27	21.86	20.80	20.00	44	35.46	34.40	33.60
11	9.06	8.00	7.20	28	22.66	21.60	20.80	45	36.26	35.20	34.40
12	9.86	8.80	8.00	29	23.46	22.40	21.60	46	37.06	36.00	35.20
13	10.66	9.60	8.80	30	24.26	23.20	22.40	47	37.86	36.80	36.00
14	11.46	10.40	9.60	31	25.06	24.00	23.20	48	38.66	37.60	36.80
15	12.26	11.20	10.40	32	25.86	24.80	24.00	49	39.46	38.40	37.60
16	13.06	12.00	11.20	33	26.66	25.60	24.80	50	40.26	39.20	38.40
17	13.86	12.80	12.00	34	27.46	26.40	25.60				
18	14.66	13.60	12.80	35	28.26	27.20	26.40				

**RoHS Compliant**

TOLERANCES ARE



煜倫股份有限公司

www.morethanall.com

DRAWING BY CY

CHECKED BY GENIUS

UNIT / mm

SCALE 1 : 1

DATE

SIZE A4

PJECTION

X, ±  
.X ± 0.20  
.XX ± 0.10  
.XXX ±  
ANG ±

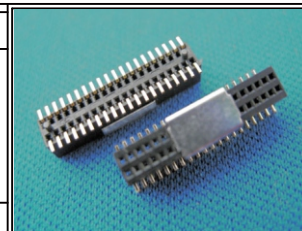

**ORDER INFORMATION**

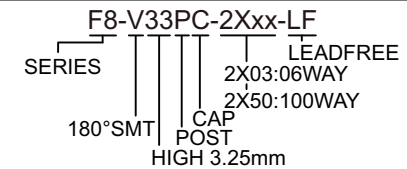

DESCRIPTION: FEMALE HEADER 0.8\*1.2mm, SMT DUAL ROWS, HEIGHT=3.0mm CAP+TAPE REEL