

Signal Segment			Power Segment		
Pin NO.	Type		Pin NO.	Type	
S1	GND		P1	V33	
S2	A+		P2	V33	
S3	A-		P3	V33	
S4	GND		P4	GND	
S5	B+		P5	GND	
S6	B+		P6	GND	
S7	GND		P7	V5	
S8	A+		P8	V5	
S9	A+		P9	V5	
S10	A-		P10	GND	
S11	GND		P11	DAS/DSS	
S12	B+		P12	GND	
S13	B+		P13	V12	
S14	GND		P14	V12	
			P15	V12	

NOTES:

***Material**

Housing: LCP+50%G.F, UL 94V-0 rated, Color: Black;
 Contact: Brass;
 Plating: Gold plating on contact area, Tin(100u" min.) plating on solder tail, Nickel (40u" min.) underplating overall

***Mechanical**

Insertion Force: 25N max.
 Withdrawal Force: 5N min.
 Durability: 500 cycles

***Electrical Specification**

Current Rating: 1.5 Ampere per contact;
 Contact Resistance: 30 mΩ max.
 Insulation Resistance: 1000 MΩ min.
 Dielectric Withstanding Voltage: 500 VAC.

***Environmental**

Operating Temperature: 0°C to +55°C

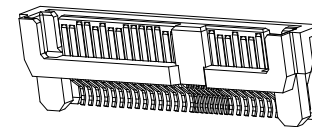
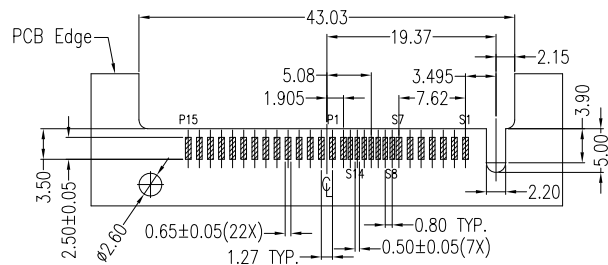
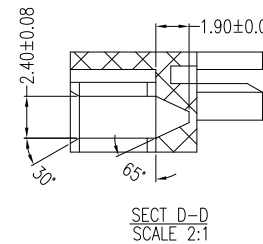
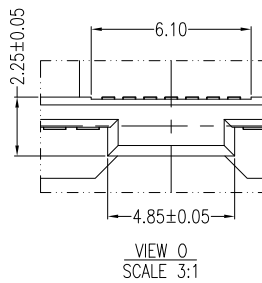
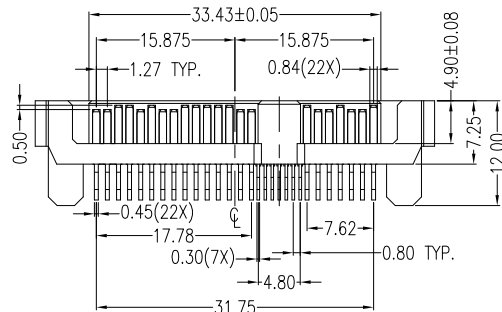
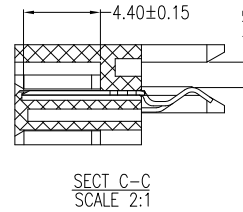
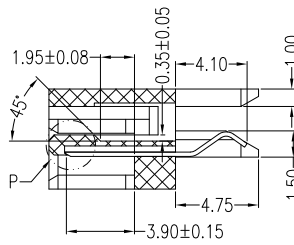
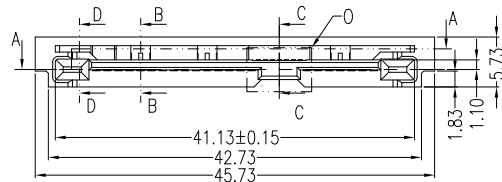

RoHS Compliant

TOLERANCES ARE

MORETHANALL
PCB CONNECTORS
Cable ASSEMBLIES

DRAWING BY CY

CHECKED BY GENIUS

UNIT / mm

SCALE 1 : 1

DATE

SIZE A4

PPOJECTION

X, ±
 X ± 0.38
 .XX ± 0.25
 .XXX ± 0.20
 ANG ± 3°

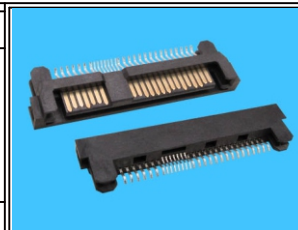

ORDER INFORMATION

SAS-PEB-29-LF
 SERIES | | | LEADFREE
 | | | 29 WAY
 | | | BRACKET
 | | | EDGE CLIP
 | | | MALE

DESCRIPTION: SAS 29P Straddle Type(1.6) Male

煜倫股份有限公司

www.morethanall.com