

- Material: Brass
- Finished: Tin-plated
- Wire range: AWG #16 ~ #22
- Thickness: 0.25mm

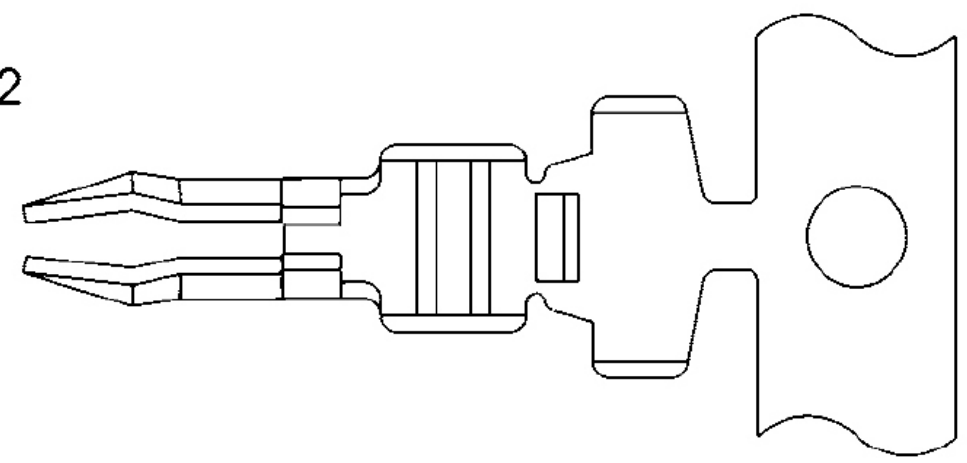

SDN-T-16-LF
LEADFREE

RoHS Compliant

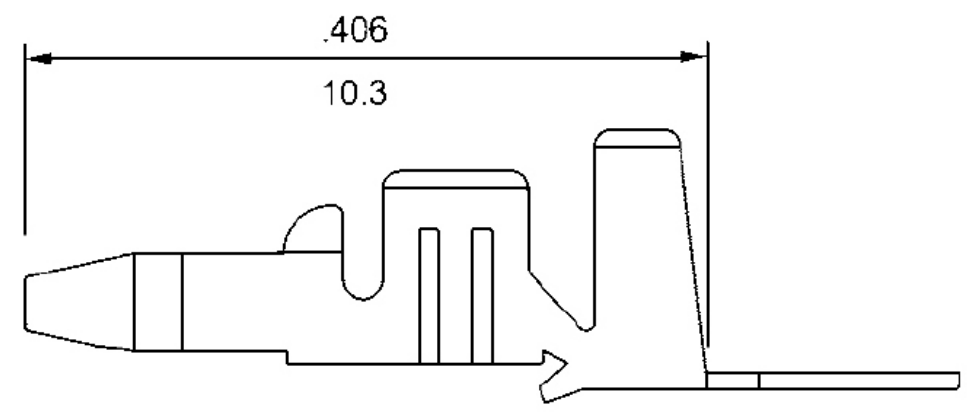

PART NO. SDN-T-16		CHECKED BY CY	TOLERANCES ARE .X ± 0.2 .XX ± .XXX ± AWG	DESCRIP TION:			
DWG NO. SDN-T-16				DRAWING BY		AREA	REVISIONS
FILE NO.		PROJECTION					
UNIT / mm	SCALE 1:1						

煜倫股份有限公司