

Features:

- 4 points contact
- Antu-fishhooking contact design
- Finished: Tin-plated (Lead free)
- Wire range: #16 ~ #22 AWG
- Thickness: 0.25mm
- Q'ty: 5000 PCS / Reel

Specification:

- Current rating: 7A
- Contact resistance: Initial 10mΩ Max.

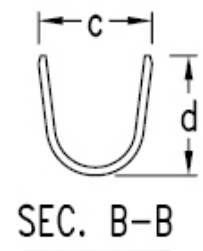
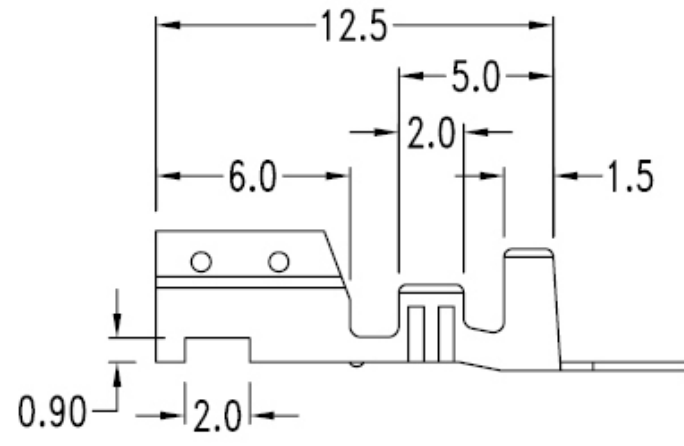
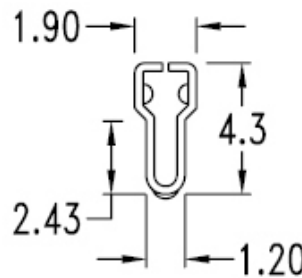
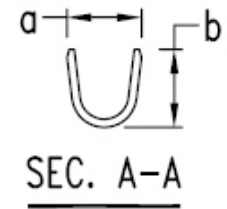
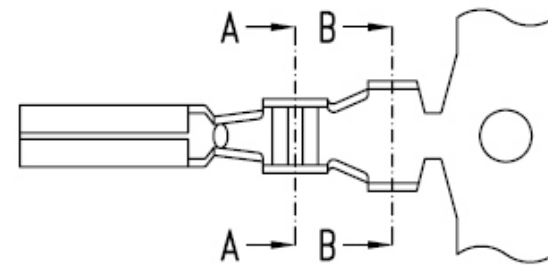

Ordering Information

Part No.	Material	Wire range	Dim. a	Dim. b	Dim. c	Dim. d
LKS-T-18	Brass	#18 ~ #22	2.3	2.4	3.5	3.6
	Phosphor bronze					
LKS-T-16	Brass	#16 ~ #18	2.45	2.4	4.0	3.9
	Phosphor bronze					

MORETHANALL
CONNECTORS
ASSEMBLIES

PART NO. **LKS-T-xx**

DWG NO. **LKS-T-xx**

FILE NO.

UNIT / mm

SCALE 1:1

CHECKED BY CY

DRAWING BY

PROJECTION

TOLERANCES ARE

.X ± 0.2

.XX ±

.XXX ±

AWG

DESCRIPTION:

AREA

REVISIONS

HK

DATE

煜倫股份有限公司