

CIRCUIT DIAGRAM

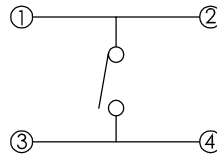

SPECIFICATION

Rating: DC 12V, 50mA Max.
Circuit: 1C - 1P.
Operating force: 160±50g.
Contact resistance: 100mΩ Max. (initial)
Travel: 0.25±0.1mm.
Life: 100,000 Cycles Min.
Minimum load: 10mA 3.3V DC.(reference only)
Soldering temperature: 250°C Max for 3 Sec.

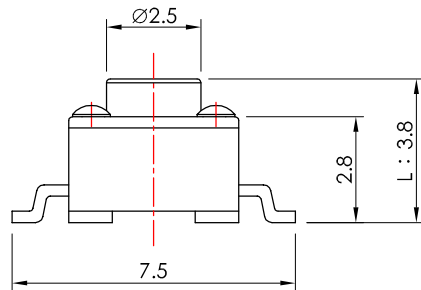

P.C BOARD MOUNTING HOLE DIMENSIONS

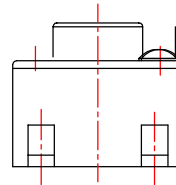

TSW44-Vxx-xxx-LF LEADFREE

MODEL NO.	L
□	3.8
A	7.0

OPERATING FORCE
160, 250

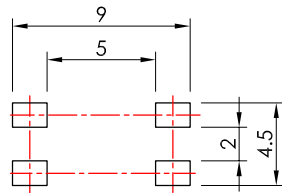

MORETHANALL
CONNECTORS
ASSEMBLIES

PART NO. TSW44-Vxx-xxx

DWG NO. TSW44-Vxx-xxx

CHECKED BY CY

TOLERANCES ARE

DESCRIP TION:

FILE NO.

DRAWING BY

.X ± 0.2
.XX ± 0.1
.XXX ±
AWG

AREA

REVISIONS

HK

DATE

煜倫股份有限公司

UNIT / mm

SCALE 1:1

PROJECTION

