

SECTION A-A

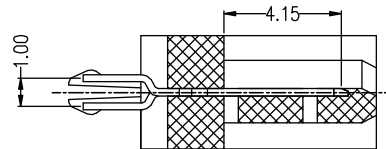

SECTION B-B

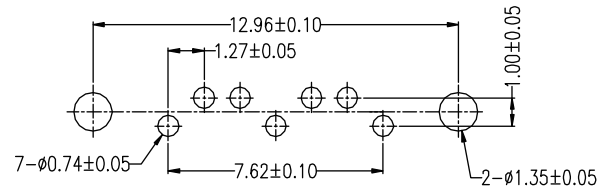
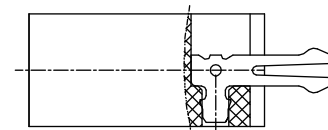

PCB LAYOUT

Notes:

*Material

Housing: LCP, UL 94V-0 rated,
Color: Black;

Contact: Brass;

Plating: Gold plating over Nickel on contact
area; Tin/Lead plating on terminal.

*Mechanical

Insertion Force: 45N max.

Withdrawal Force: 10N min.

Durability: 500 cycles.

*Electrical Specification

Current Rating: 1.5 Ampere per contact;

Contact Resistance: 30 Milliohms max.

Insulation Resistance: 1000 megohms min.

Dielectric Withstanding Voltage: 500 V AC.

*Environmental

Operating Temperature: -55°C to +125°C

RoHS Compliant

TOLERANCES ARE

MORETHANALL
PCB CONNECTORS
Cable ASSEMBLIES

DRAWING BY CY

X, ±

CHECKED BY GENIUS

.X ± 0.38

UNIT / mm

SCALE 1 : 1

.XX ± 0.25

DATE

.XXX ±

ANG ±

SIZE A4

P PROJECTION

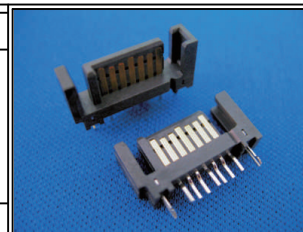

ORDER INFORMATION

SATA-PDR10ZB-07-LF

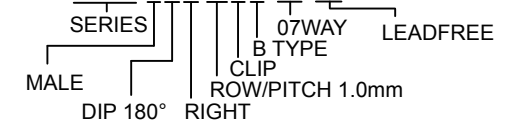

DESCRIPTION: SATA 7Pin 直立DIP A型(2.05mm)(鑿入麻叉型)

煜倫股份有限公司

www.morethanall.com