

**Material:**

Contact: Copper Alloy With Gold Plated.

Lock Link: Copper Alloy With Nickel Plated.

**\*RoHS Compliant**

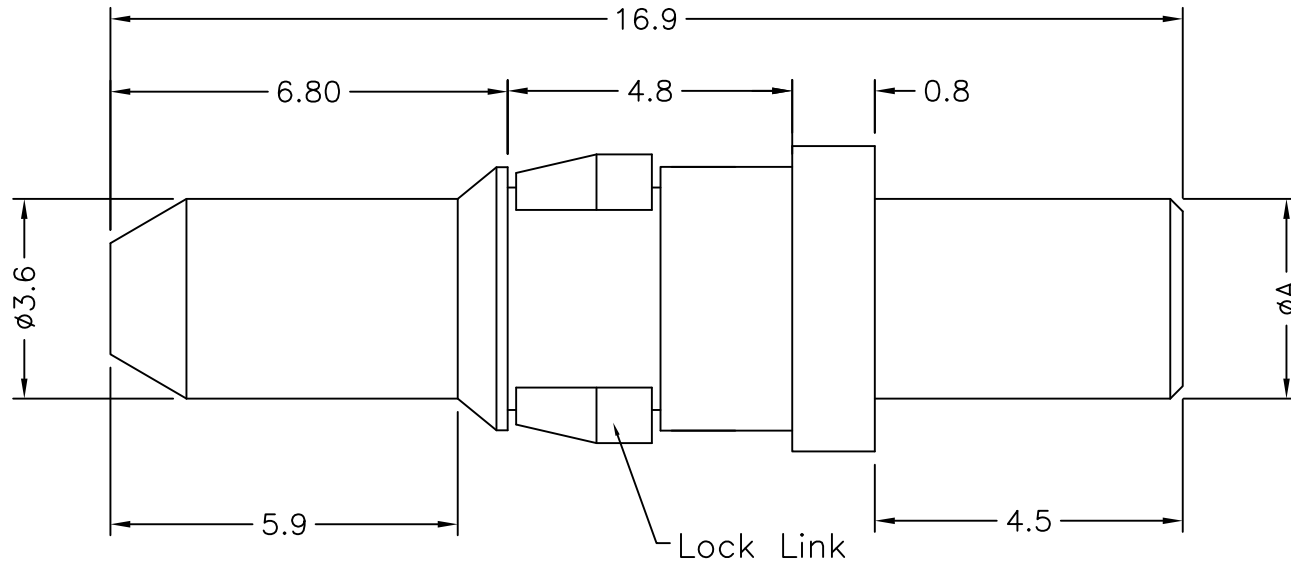

Current Rating (Amps)	Dimension
	$\phi A$
40	3.75
30	3.17
20	2.85
10	1.70

**RoHS Compliant**

TOLERANCES ARE

**MORETHANALL**  
PCB CONNECTORS  
Cable ASSEMBLIES

煜倫股份有限公司

www.morethanall.com

DRAWING BY CY

CHECKED BY GENIUS

UNIT / mm

SCALE 1 : 1

DATE

SIZE A4

PPOJECTION

X.  $\pm$  0.35  
.X  $\pm$  0.25  
.XX  $\pm$  0.15  
.XXX  $\pm$   
ANG  $\pm$



**ORDER INFORMATION**

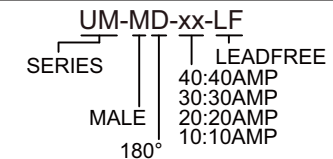

DESCRIPTION: Power Pin Male Straight Type