

R Type PCB layout for normal

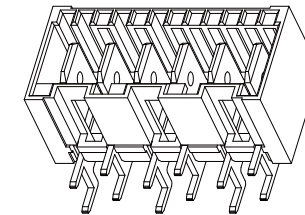

NORMAL

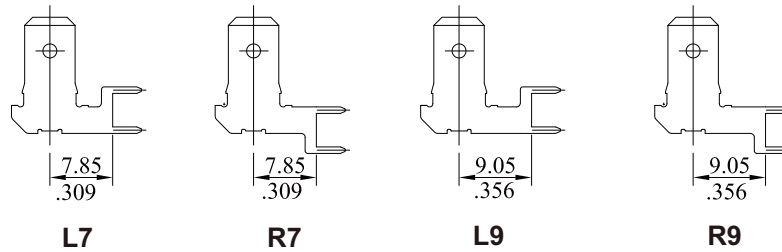
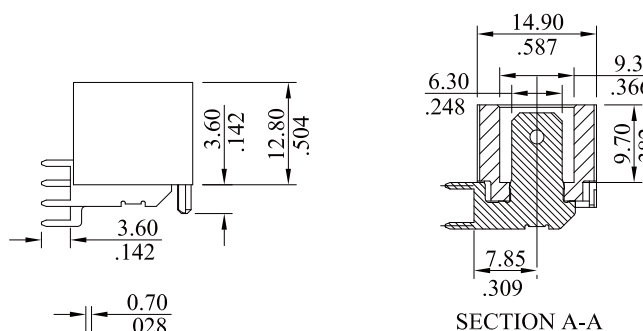

SECTION A-A

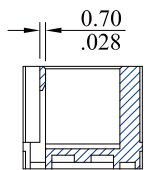

SECTION B-B

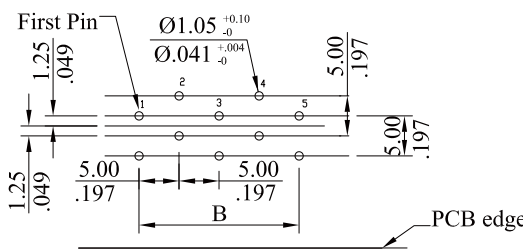

L Type PCB special layout for normal

Note:

1. Material: Insulator: PA66+30% G/F UL94V-0

Terminal: Copper alloy

2. Contact:

Tin Plated 120 u" over Ni 30 u" min

Silver Plated 80~120 u" over Ni 30 u" min

12	62.0(2.441)	55.0(2.165)	60.2(2.370)
11	57.0(2.244)	50.0(1.969)	55.2(2.173)
10	52.0(2.047)	45.0(1.712)	50.2(1.975)
9	47.0(1.850)	40.0(1.575)	45.2(1.780)
8	42.0(1.654)	35.0(1.378)	40.2(1.583)
7	37.0(1.457)	30.0(1.181)	35.2(1.386)
6	32.0(1.260)	25.0(.984)	30.2(1.189)
5	27.0(1.063)	20.0(.787)	25.2(.992)
4	22.0(.886)	15.0(.591)	20.2(.795)
3	17.0(.669)	10.0(.394)	15.2(.598)
2	12.0(.472)	5.0(.197)	10.2(.402)
CIRCUITS	DIM.A	DIM.B	DIM.C

RoHS Compliant

**MORETHANALL**  
PCB CONNECTORS  
Cable ASSEMBLIES

煜倫股份有限公司

www.morethanall.com

DRAWING BY CY

CHECKED BY GENIUS

UNIT/ mm SCALE 1:1

DATE

SIZE A4

TOLERANCES ARE

X, ±  
X ± 0.30  
.XX ± 0.20  
.XXX ± 0.10  
ANG ± 1°

PJECTION

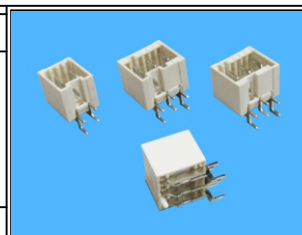

ORDER INFORMATION

RST50-PRAxy-xx0yy-LF

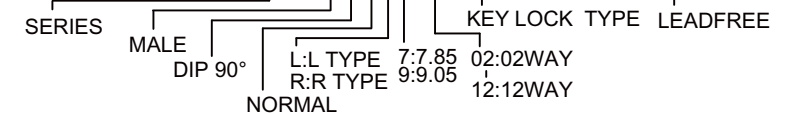

DESCRIPTION:

TYPE	0A	0B	0C	0D	0E	0F	0G	0H	0I	0J	0K	0L	0M	0N
KEY/LDCK 2-way														

0P	0Q	0R	0S	0T	0U	0X	0Z	09	10	11	48	80	86

TYPE	0A	0B	0C	0D	0E	0F	0G	0H	0I	0K	0L
KEY/LDCK 3-way											

0M	0N	0Q	0w	02	03	04	05	10	12	13

1A	2N	2P	32	38	40	44	53	65	80	81

98

TYPE	0A	0B	0C	0D	0E	0F	0G	0H	0I
KEY/LDCK 4-way									

0J	0K	0L	0M	0w	01	02	03	04

05	06	17	19	37	43	63	65	80

81	82	84	86	GA(Green)	PA	PB

2~4 Key way

RoHS Compliant

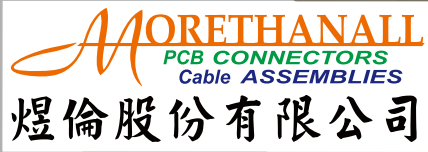

www.morethanall.com

DRAWING BY CY  
CHECKED BY GENIUS  
UNIT/ mm SCALE 1:1  
DATE  
SIZE A4

TOLERANCES ARE  
X, ±  
.X ± 0.30  
.XX ± 0.20  
.XXX ± 0.10  
ANG ± 1°  
PJECTION

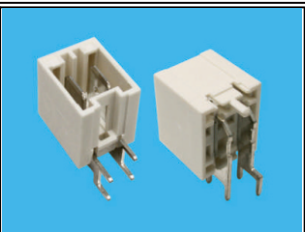

ORDER INFORMATION

RST50-PRAXY-xx0yy-LF

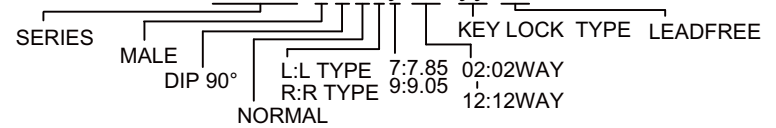

DESCRIPTION:

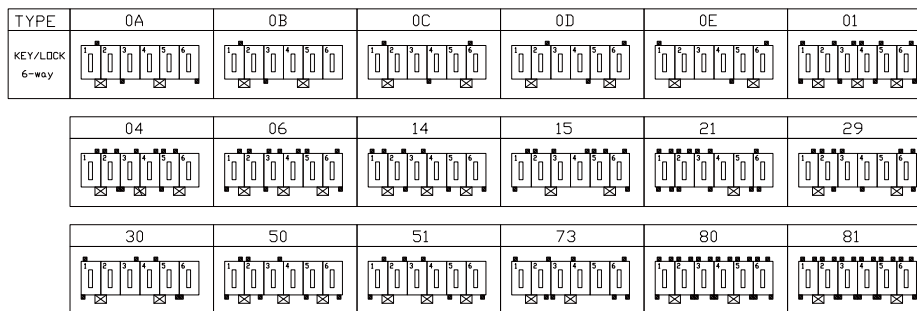
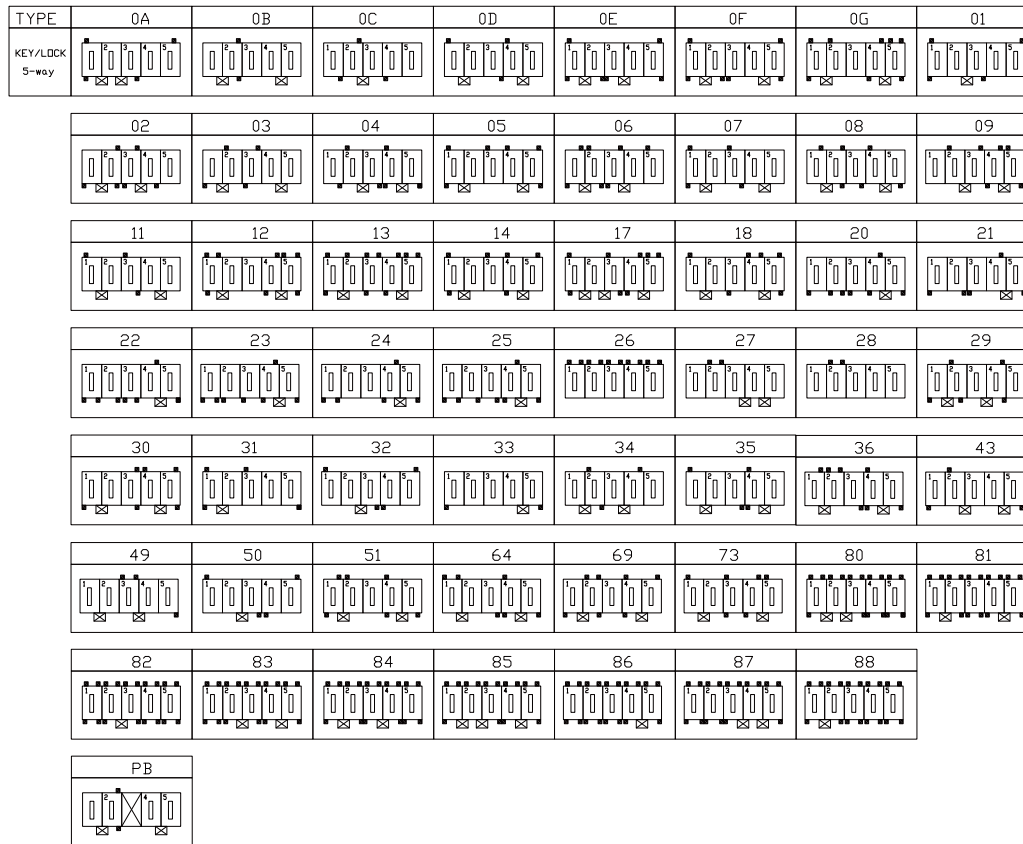

5~6 Key way

**MORETHANALL**  
PCB CONNECTORS  
Cable ASSEMBLIES

煜倫股份有限公司

www.morethanall.com

RoHS Compliant

DRAWING BY CY

CHECKED BY GENIUS

UNIT/ mm SCALE 1:1

DATE

SIZE A4

TOLERANCES ARE

X, ±  
.X ± 0.30  
.XX ± 0.20  
.XXX ± 0.10  
ANG ± 1°

PJECTION

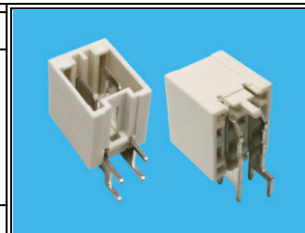

ORDER INFORMATION

RST50-PRAXy-xx0yy-LF

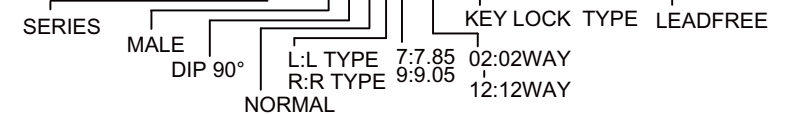

DESCRIPTION:

TYPE	0A	0B	1B	0C	0E	03
KEY/LOCK 7-way						
	04	14	22	23	30	31
	32	34	35	38	40	41
	42	43	45	48	51	59
	69	76	80	81	83	P6

TYPE	0A	0C	0D	08	10	21
KEY/LOCK 8-way						
	30	33	41	44	45	46
	48	49	57	58	62	63
	77	80	81			

TYPE	0A	0B	0C	0D	08
KEY/LOCK 9-way					
	31	42	43	48	49
	52	53	57	58	
	80	81			

7~9 Key way

**MORETHANALL**  
PCB CONNECTORS  
Cable ASSEMBLIES

煜倫股份有限公司

www.morethanall.com

RoHS Compliant

DRAWING BY CY

CHECKED BY GENIUS

UNIT/ mm SCALE 1:1

DATE

SIZE A4

TOLERANCES ARE

X, ±  
X ± 0.30  
.XX ± 0.20  
.XXX ± 0.10  
ANG ± 1°

PJECTION

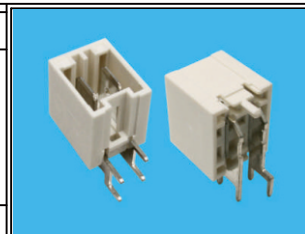

ORDER INFORMATION

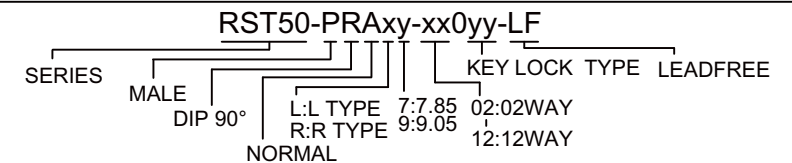

DESCRIPTION:

TYPE	0A	01	02	30
KEY/LOCK 10-way				
	36	46	50	51
	52	64	70	72
	74	75	76	80

TYPE	0A	0B	0C	01
KEY/LOCK 11-way				
	13	33	55	60
	64	80		

TYPE	27	30	59	65
KEY/LOCK 12-way				
	80			

10~12 Key way

**MORETHANALL**  
PCB CONNECTORS  
Cable ASSEMBLIES

煜倫股份有限公司

www.morethanall.com

**RoHS Compliant**

DRAWING BY CY

CHECKED BY GENIUS

UNIT/ mm SCALE 1:1

DATE

SIZE A4

TOLERANCES ARE

X, ±  
.X ± 0.30  
.XX ± 0.20  
.XXX ± 0.10  
ANG ± 1°

PJECTION

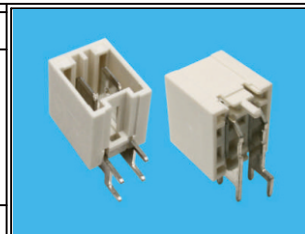

**ORDER INFORMATION**

**RST50-PRAXy-xx0yy-LF**

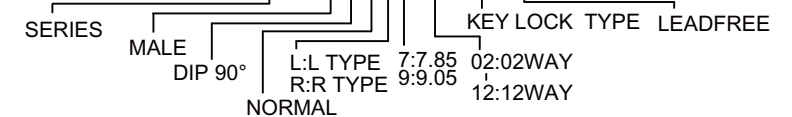

DESCRIPTION: